

# Cork County Council



## Proposed Traffic Calming Scheme at L1246 River Valley, Mallow, Co Cork

### Drawing Schedule

Drawing No.	Drawing Title	Rev.	Scale	Size
L1246-LM-01_D1	Location Map	D1	NTS	A3
L1246-LA-01_A1	Proposed Layout	A1	1:250	A1

**Section 38**

**Regional & Local Road Design Office**

Floor 3  
County Library Building  
Carrigrohane Road, Cork, T12 K335.

**May 2024**

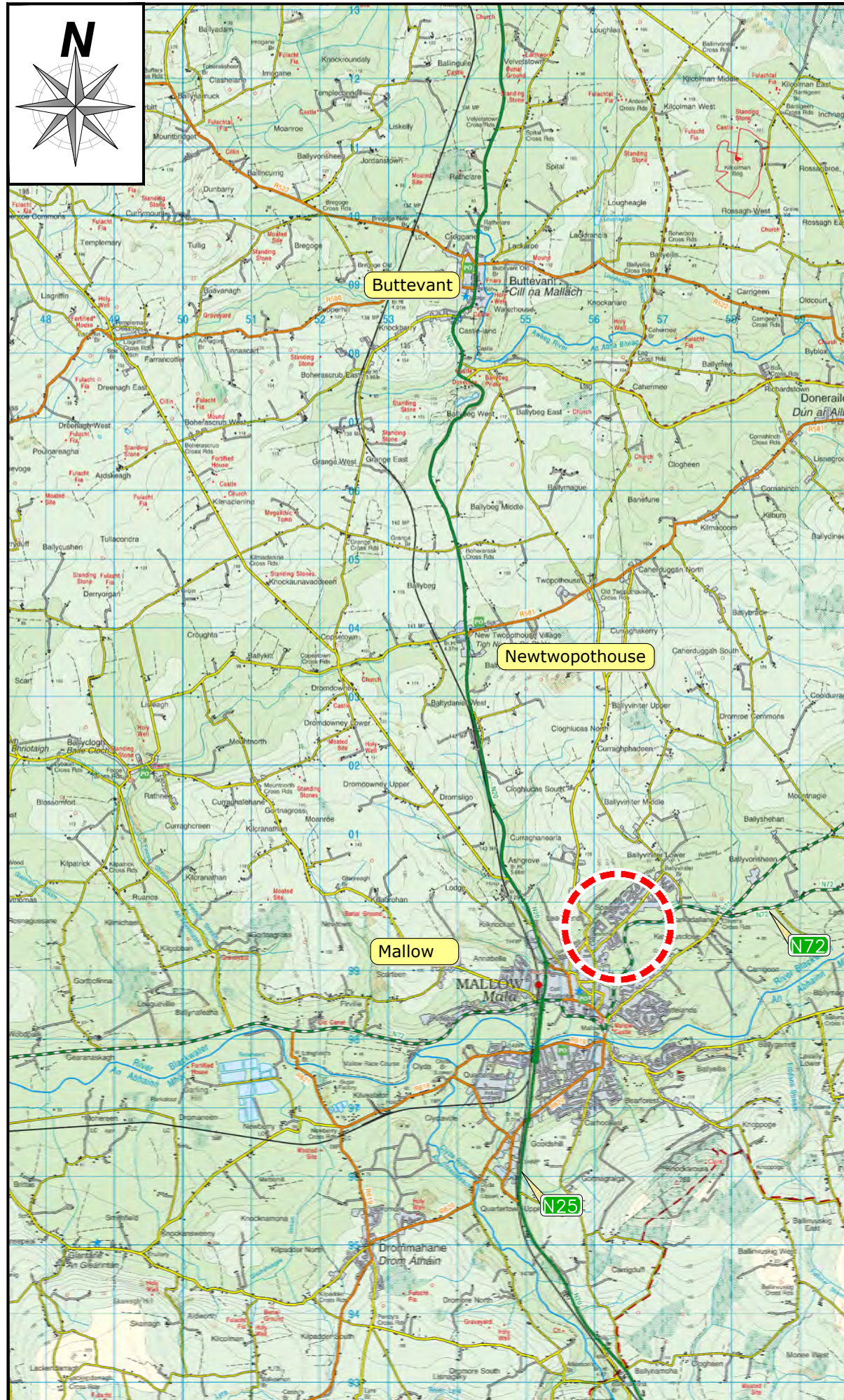

Not to Scale

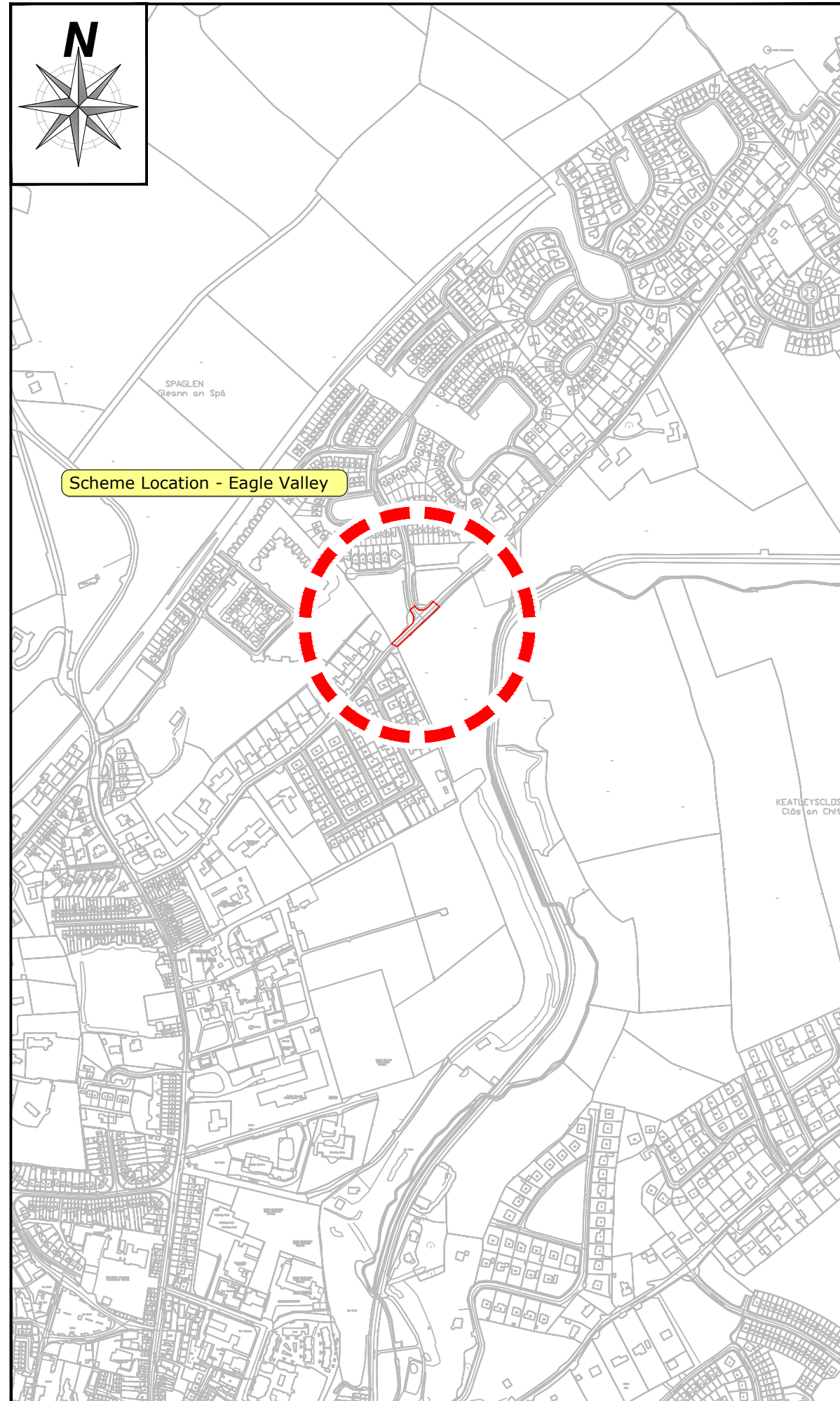

Not to Scale

Rev	By	Date	Description
© Copyright			
The information on this drawing is confidential and must not be disclosed to any third party or reproduced, in whole or part, without the express written consent of Cork County Council. All drawings remain the property of Cork County Council.			
Includes Ordnance Survey Ireland data reproduced under OSI Licence number 2020 OSI, NIA, OAS. Unauthorised reproduction infringes Ordnance Survey Ireland and Government of Ireland copyright. © Ordnance Survey Ireland, year 2021.			
<b>CORK COUNTY COUNCIL</b> Regional & Local Roads Design Office Floor 3 County Library Building Carrigrohane Road Cork T12 K335			
Project:			
<b>L1246 River Valley Pedestrian Crossing</b>			
Title:			
Location Map			
<small>File Path: C:\Users\jaden\p\h\Desktop\CCC_P\Projects\Projects 2024\Mallow_Schemes\L1246-LM-01.dwg</small>			
AL	AL	**	**
21 May 2024			NTS
Section 38			A3
L1246-LM-01			D1

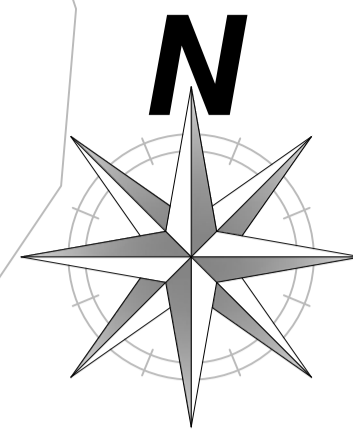

River Valley Housing Estate

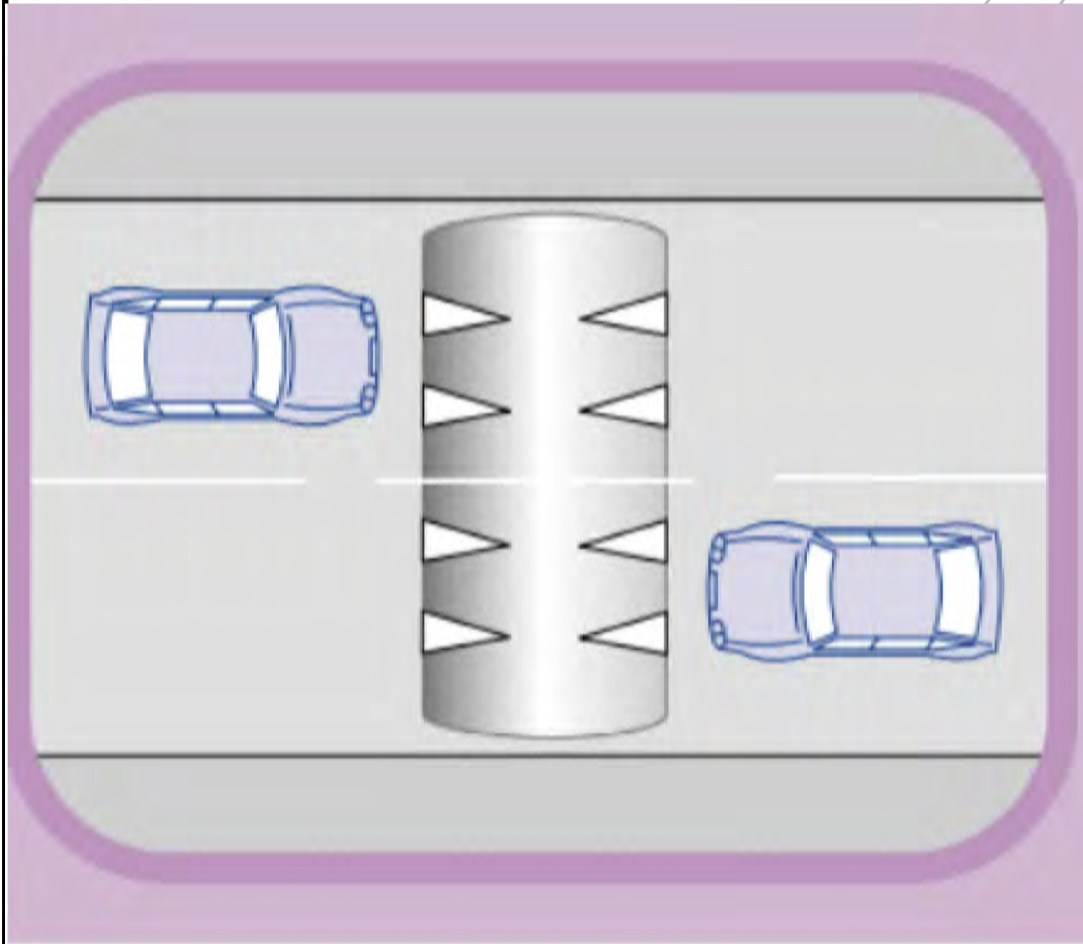
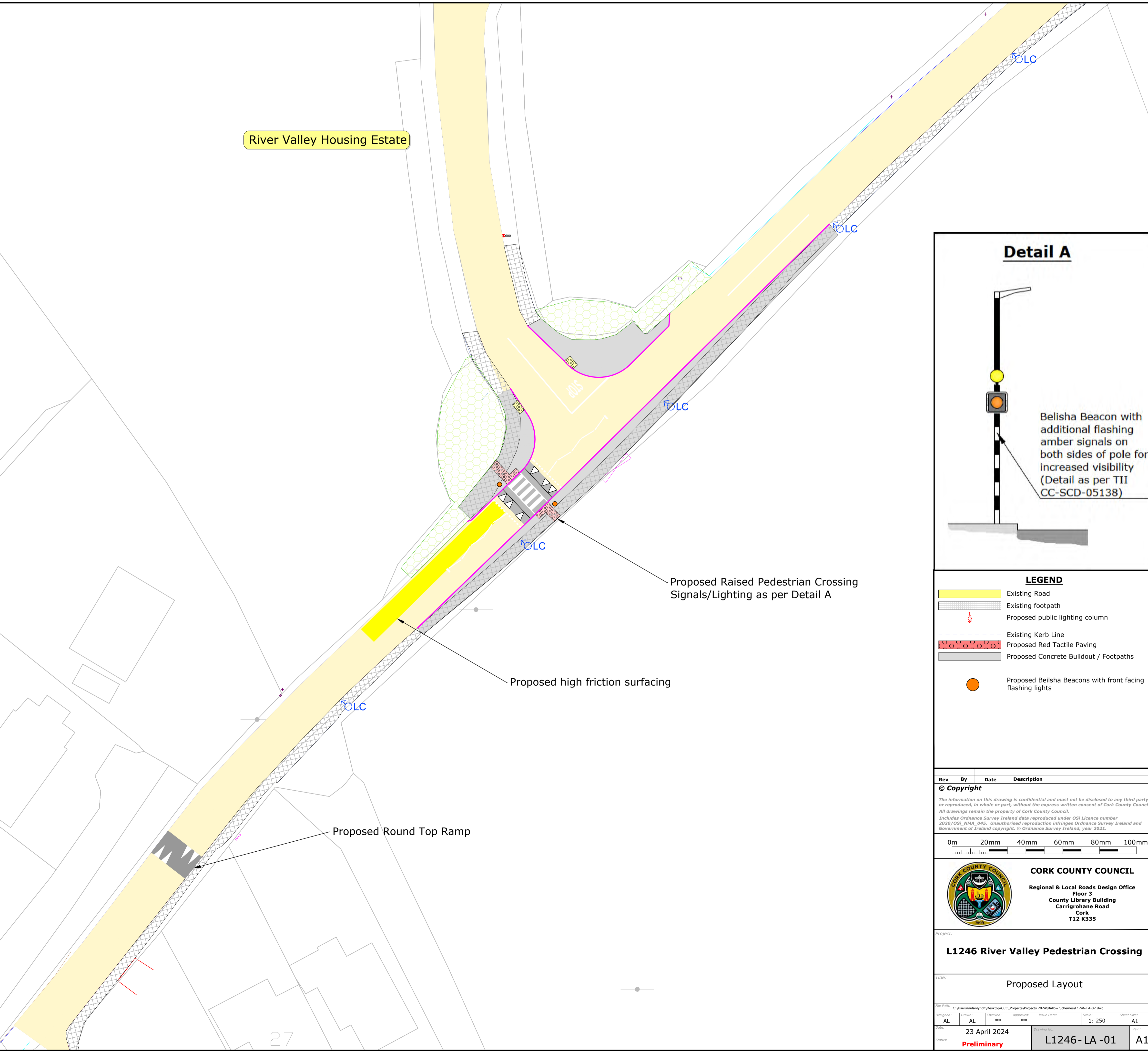
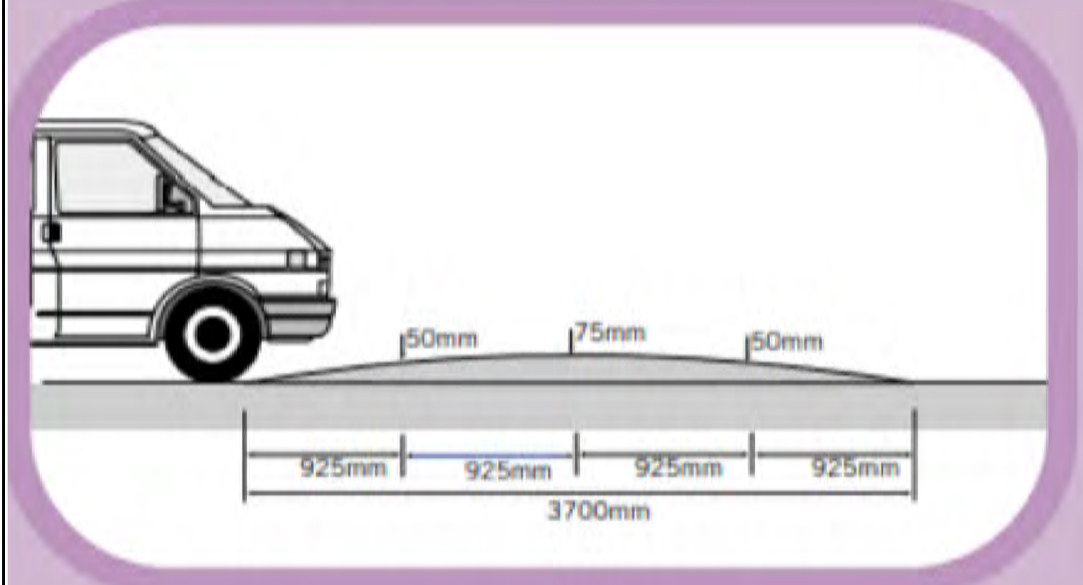
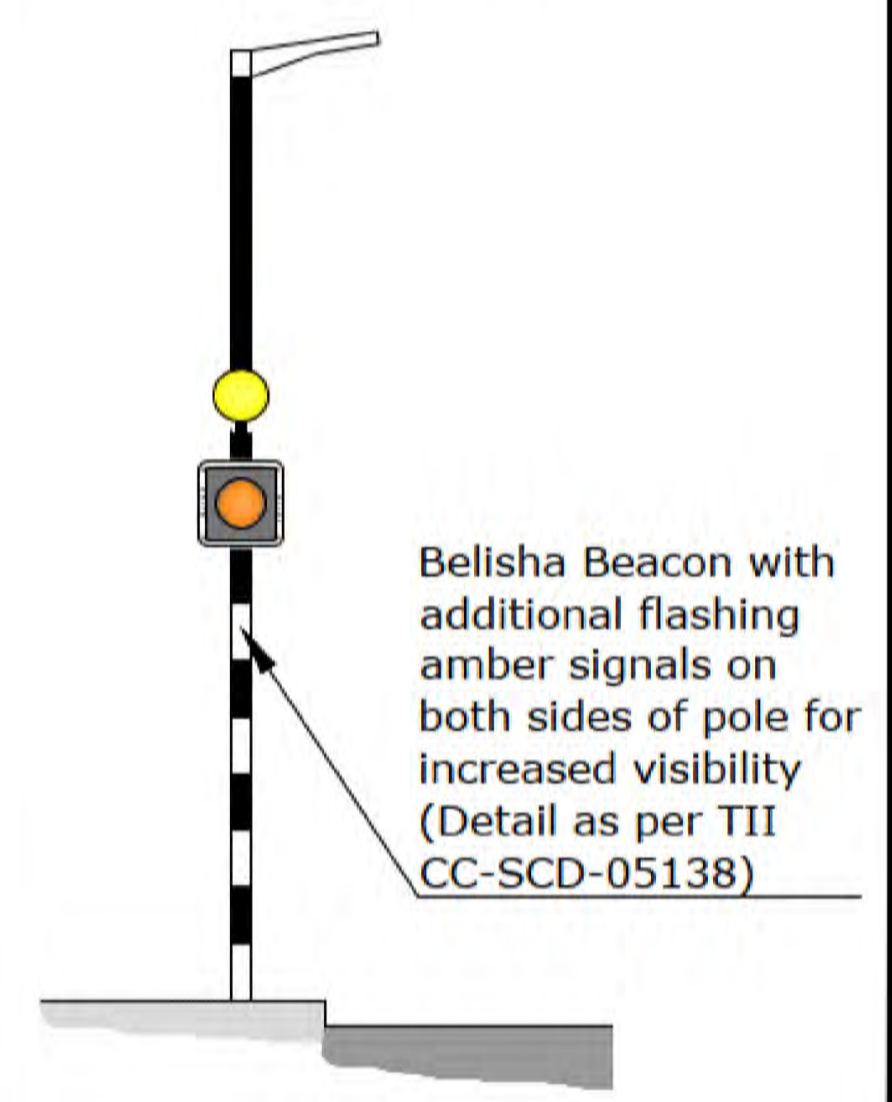

Diagram 6.32 Cross section of 75mm high round-top ramp



**Detail A**



**LEGEND**

- Existing Road
- Existing footpath
- Proposed public lighting column
- Existing Kerb Line
- Proposed Red Tactile Paving
- Proposed Concrete Buildout / Footpaths
- Proposed Belisha Beacons with front facing flashing lights

Rev	By	Date	Description
© Copyright			

The information on this drawing is confidential and must not be disclosed to any third party or reproduced, in whole or part, without the express written consent of Cork County Council. All drawings remain the property of Cork County Council. Includes Ordnance Survey Ireland data reproduced under OSI Licence number 2020/OSI\_NWA\_042. Unauthorised reproduction infringes Ordnance Survey Ireland and Government of Ireland copyright. © Ordnance Survey Ireland, year 2021.

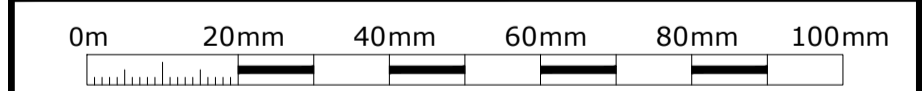

**CORK COUNTY COUNCIL**  
Regional & Local Roads Design Office  
Floor 3  
County Library Building  
Carrigrohane Road  
Cork  
T12 K335

Project: **L1246 River Valley Pedestrian Crossing**

Title: **Proposed Layout**

Prepared by:	Checked by:	Approved by:	Issue Date:	Scale:	Sheet No.:
AL	AL	**	**	1: 250	A1
Date:	23 April 2024		Drawing No. <b>L1246 - LA -01</b>		
Status:	<b>Preliminary</b>		Sheet: <b>A1</b>		