

49m sightlines (purple) with a 2.4m setback from edge of the carriageway. The sightlines are in accordance with DMURS table 4.2 for a 50km/h design speed and must be kept clear of all objects large enough to obscure a vehicle, pedestrian or cyclist. Foliage to be permanently cut back/removed where necessary. Nothing shall be planted within the sightline triangle without written permission from Cork County Council. Any boundary walls etc. within the sightline triangle shall have a max. height of 0.8m.

M114 (Stop road Marking)
RRM 017 (Stop Line)
RRM 001 (Solid centre Line)
Extends back 10m from the stop line



RUS 027: STOP

Proposed uncontrolled crossing at road level. Dropped kerbs to bring the footpath level down to match the road level at the tactile paving. (See Detail)

Existing wall, ditch, trees to be removed here in order to achieve sightlines as shown

75mm high ramp x 1125mm in length (1:15 gradient) to raised section of road and carpark (See Detail).

Proposed uncontrolled crossing on the L-2216 in accordance with the Traffic Management Guidelines. Crossing formed with the addition of 75mm depth of bituminous surfacing as per the detail. Ramped on both sides at a gradient of 1:15. Minimum flat surface width across the top of 2.5m. Marked with M112 Traffic Calming Triangles.

Dropped kerbs to match footpath level with the top of the crossing, at the tactile paving.

Standard black Bituminous surfacing - see WDG drawing no. 24004-XX-XX-XX-DR-WDG-CE-504 for road, footpath, kerb construction details

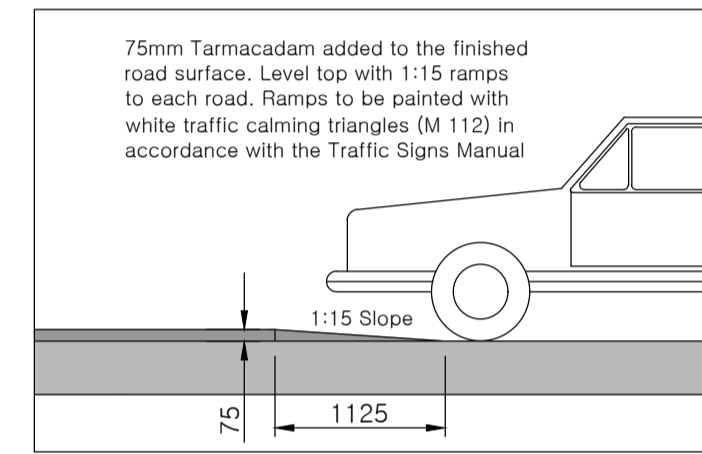

Raised Junction/Table Ramp Detail
Scale 1:50

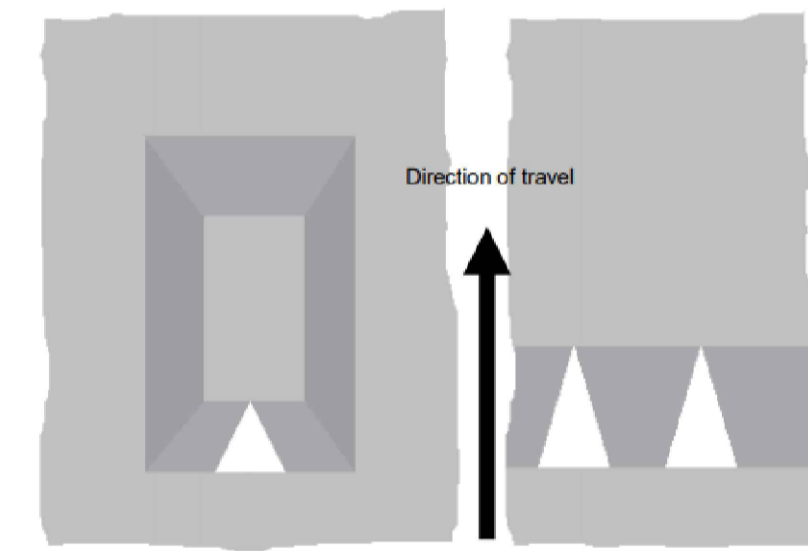
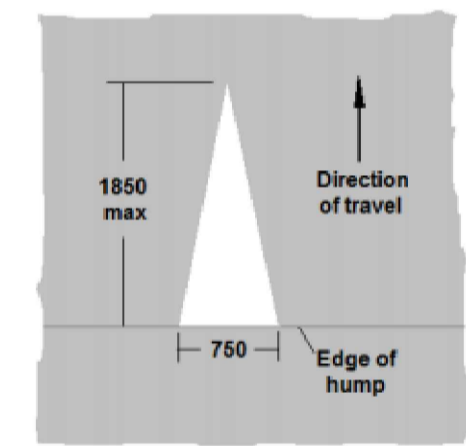
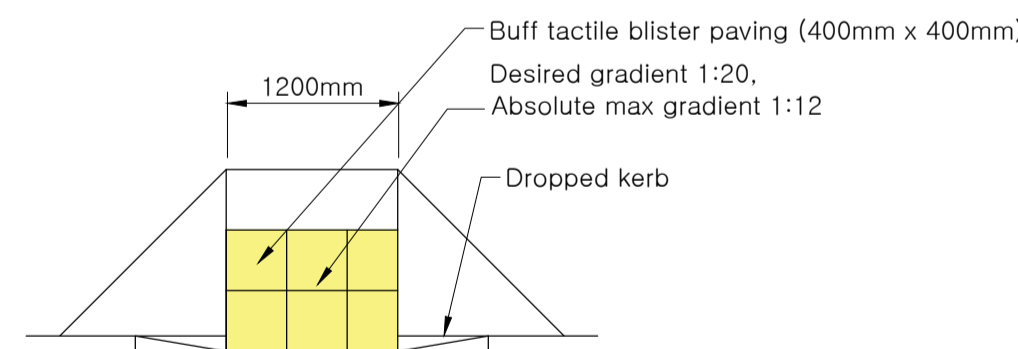

Figure 7.57:
Traffic Calming Triangle on Speed Cushion and Speed Hump



M 112
Traffic Calming Triangle



Uncontrolled pedestrian crossing path/kerb
Scale 1:50

- Tactile Paving Note:
1. Uncontrolled crossings in accordance with 'Traffic Management Guidelines' DOT, 2019.
 2. Module type B (400mm x 400mm) only is shown here and shall be used.
 3. Tactile blister paving shall be bedded on 25mm moist sand/cement mortar (3:1), joints filled with 4:1 mix to within 2mm of the paving surface.
 4. Dropped kerb shall have a maximum up-stand of 6mm.

General Notes

All drawings are to be read in conjunction with all relevant specifications, bills of quantities, architectural Services and engineering drawings.
Any discrepancies between these documents shall be brought to the attention of the engineer and architect.
All dimensions are in millimetres, unless noted otherwise.
Figured dimensions take precedent over scaled dimensions.
The contractor is responsible for all temporary works.
The contractor must prepare a method statement and submit it to the engineer/architect prior to the undertaking of any structural or civil engineering work.

Note: It is the responsibility of the main contractor (Builder under the BCAR) to ensure that all work is completed in accordance with the Building Regulations & the latest relevant Technical Guidance Documents.

Issued For Planning	15/04/24	IR
Issued for tender	02/04/24	IR
Revised Description	17/04/24	IR

walsh design group

Consulting Engineers
The Mall, Maryborough Woods, Douglas, Cork
Tel: 021-4774940 email: info@wdg.ie

Title:	Site Layout Roads & Levels
Project:	Proposed Residential Development Cloughduv, Co. Cork

ID No:	24004-XX-XX-XX-DR-WDG-001
Date:	Feb 2024
Drawn by:	IR
Scale:	1:250
Purpose:	P3- Planning

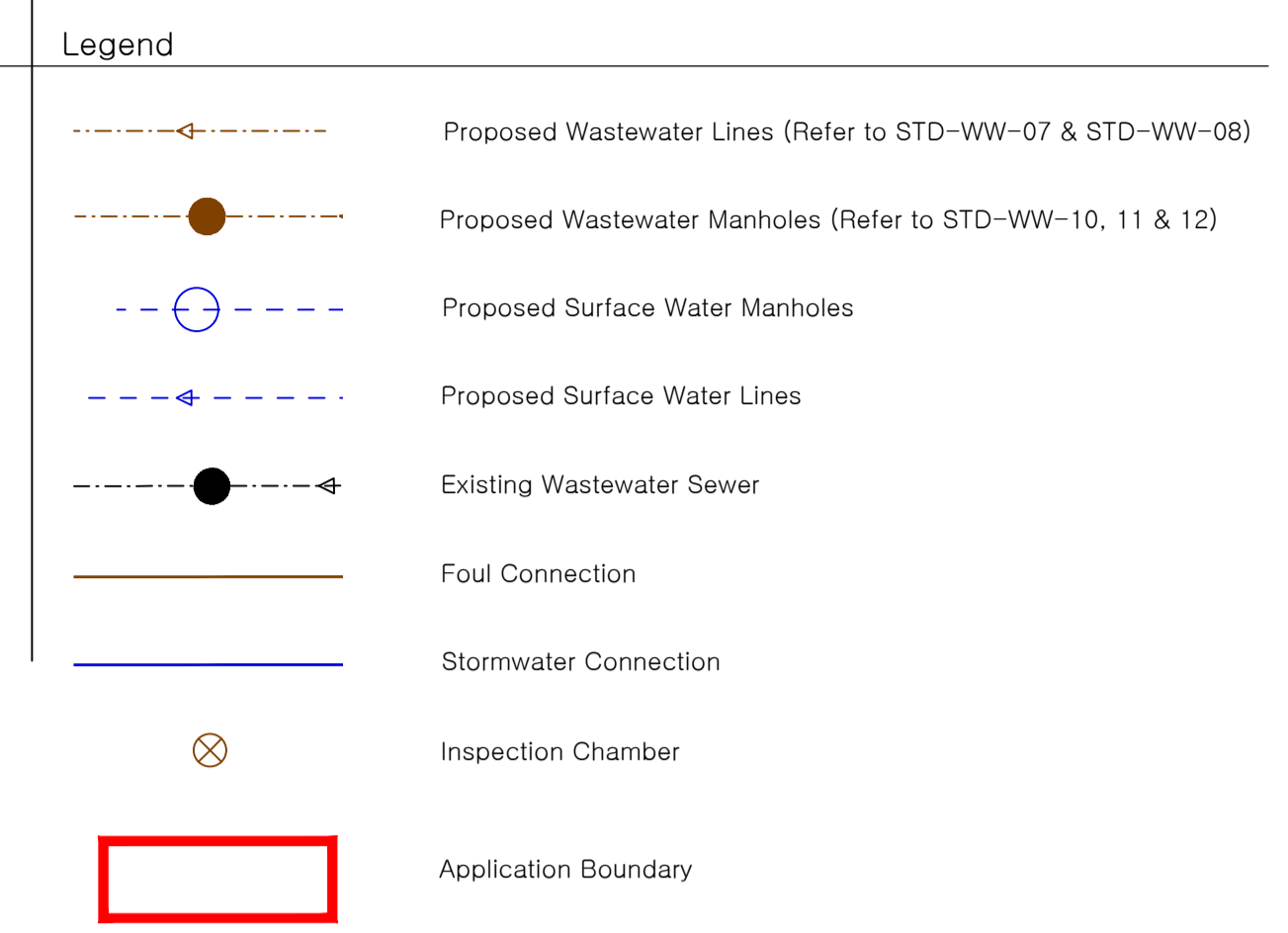
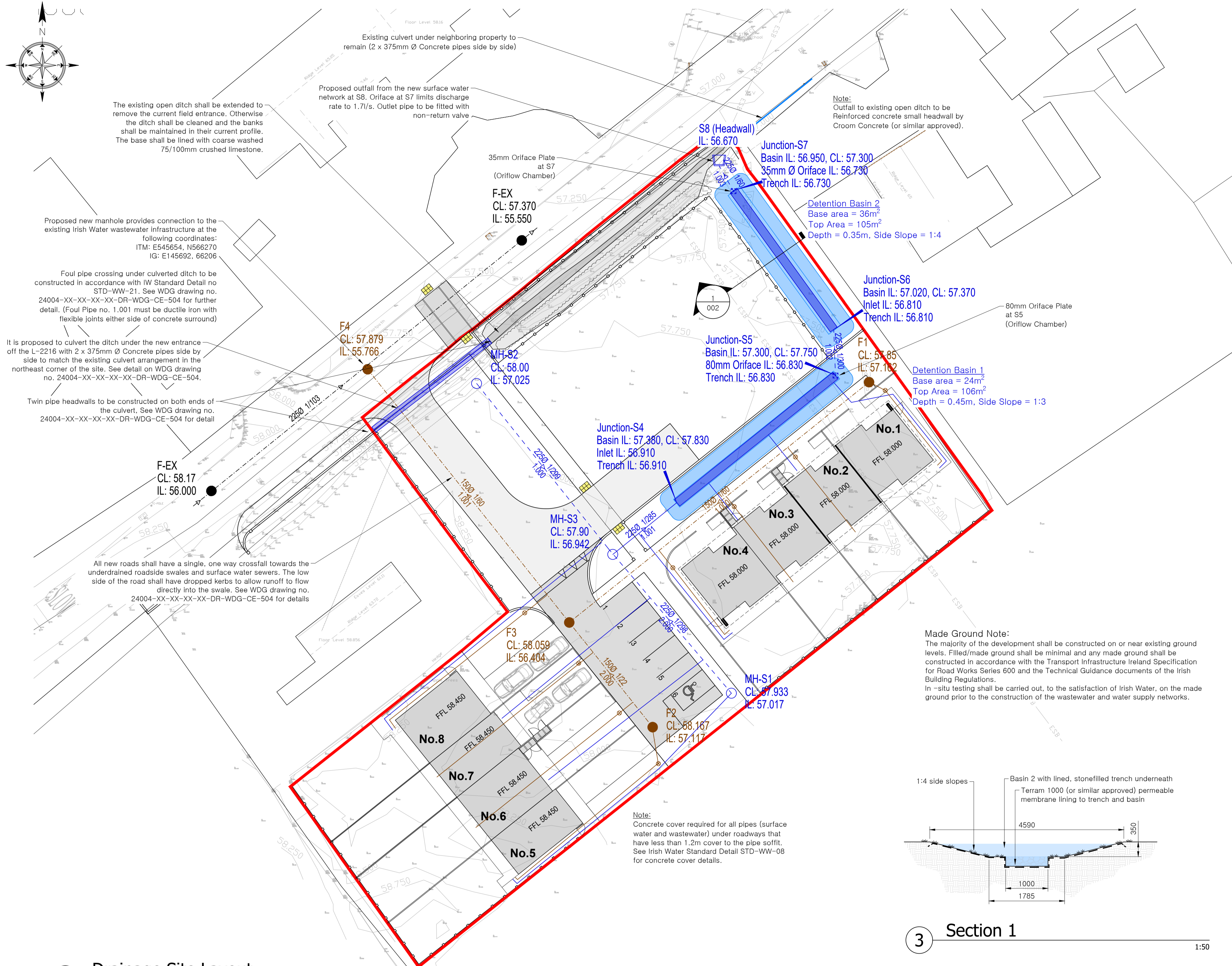
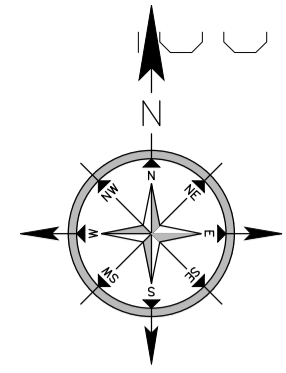

See the following accompanying WDG drawings for drainage details:
 • Surface Water Drainage Typical Details 24004-XX-XX-XX-DR-WDG-CE-500.
 • Irish Water Standard Details - Wastewater 24004-XX-XX-XX-DR-WDG-CE-501.

- Notes:
- All Levels are relative to Ordnance Datum.
 - All coordinates are ITM.
 - Minimum cover to pipes under roadways to be 1200mm. Where this can not be achieved, concrete surround and cover shall be provided in accordance with Irish Water requirements - see accompanying standard details drawing.
 - Ensure that the Correct underside Build up of the Cover and Frame is as per STD-WW-10 (or relevant) and COP section 3.12.9
 - Manholes in Roadways are to be to IS EN 124, with D400 load capacity Ensure that the Manhole "covers, where located in grass areas, shall be surrounded by a concrete plinth, 200mm"
 - Manhole covers and Frames shall comply with COP section 3.12.9.
 - Maximum distance between manholes to be in accordance with COP section 3.5.8.
 - All manholes shall be constructed in accordance with COP Section 3.12.
 - SW pre-cast manhole rings to have a minimum of 150mm of concrete surround where depth to invert exceeds 2.0m.
 - Pipe joining shall be as per manufacturers instructions
 - All sewer pipes will be uPVC and will have a minimum 3.2mm wall thickness and SN8 stiffness class. Sewer pipes will comply with section 3.13 of the IW Code of Practice for Wastewater Infrastructure (Rev2) July 2020.
 - All foul and storm water pipes running close to houses to have a horizontal distance from the foundations of at least double the vertical distance from the bottom of the foundations to the invert level of the pipe.
 - Storm water shall not be permitted to enter the foul sewer.
 - All connections to the foul sewer shall be made using Tee pieces built into the main line.
 - Built in connections to the foul sewer to facilitate the installation of washing machines and dishwashers to be provided.
 - A separate foul service pipe is to be taken from each house to the main sewer. Common drains are not permitted for use.
 - An inspection chamber in compliance with IW Standard Details STD-WW-03 (Rev2) and STD-WW-13 (Rev3) will be located within the curtilage of each premises or within 1m of the premises as per section 3.11.14 of the wastewater Code of Practice.
 - The maximum backdrop permitted in foul manholes is 2.5m - refer to section 3.6 of the Wastewater Code of Practice and STD-WW-12 for more detail.
 - The external face of proposed manhole chambers will be constructed a minimum of 0.5m from a kerb line and the external face of a sewer line will be constructed a minimum of 1.0m from a kerb line in accordance with section 3.5.16 of the Wastewater Code of Practice.
 - Wastewater pipes shall be separated from all other pipes and ducts by a minimum of 300mm unless the other service provider has a greater requirement.
 - Wastewater service pipes shall be separated from new IW infrastructure by a minimum of 150mm and from all other pipes and ducts by a minimum of 300mm unless the other service provider has a greater requirement.
 - All foul sewer construction details for both gravity sewers and rising mains to comply with the following Irish Water Documents:

Made Ground Note:
 The majority of the development shall be constructed on or near existing ground levels. Filled/made ground shall be minimal and any made ground shall be constructed in accordance with the Transport Infrastructure Ireland Specification for Road Works Series 600 and the Technical Guidance documents of the Irish Building Regulations.
 In-situ testing shall be carried out, to the satisfaction of Irish Water, on the made ground prior to the construction of the wastewater and water supply networks.

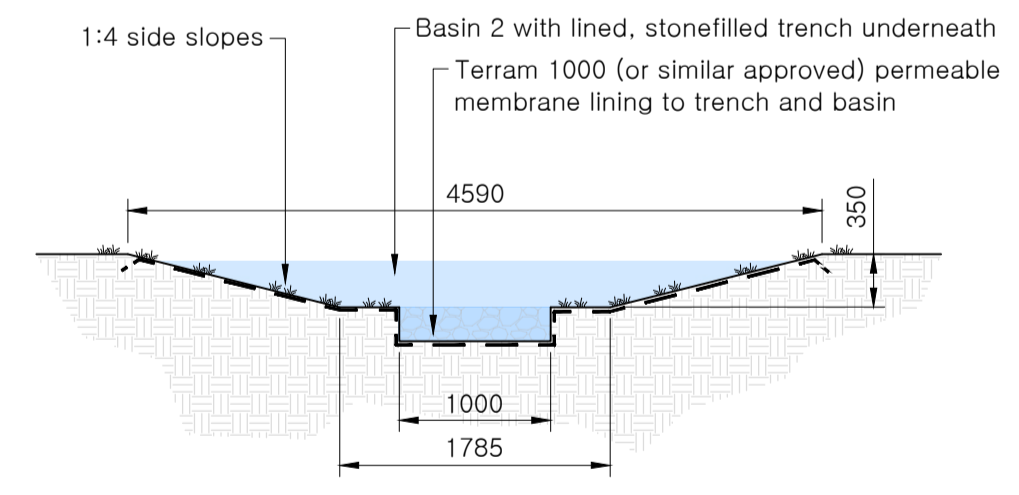

3 Section 1 1:50

Note: It is the responsibility of the main contractor (Builder under the BCAR) to ensure that all work is completed in accordance with the Building Regulations & the latest relevant Technical Guidance Documents.

2	Issued For Planning	15/04/24	RF	IR
1	Approved for IW	10/04/24	RF	MW
0	Issued for tender	02/04/24	RF	MW
Rev	Description	Date	By	Chk

walsh design group
 Consulting Engineers
 The Mall, Maryborough Woods, Douglas, Cork
 Tel: 021-4774940 email: info@wdg.ie

Title:	Site Layout Drainage
Project:	Proposed Residential Development Cloughduv, Co. Cork
ID No:	24004-XX-XX-XX-DR-WDG-002
Date:	Feb 2024
Drawn by:	IR
Scale:	1:250
Purpose:	P3 - Planning
Rev:	2

1 Drainage Site Layout

Scale: 1:250

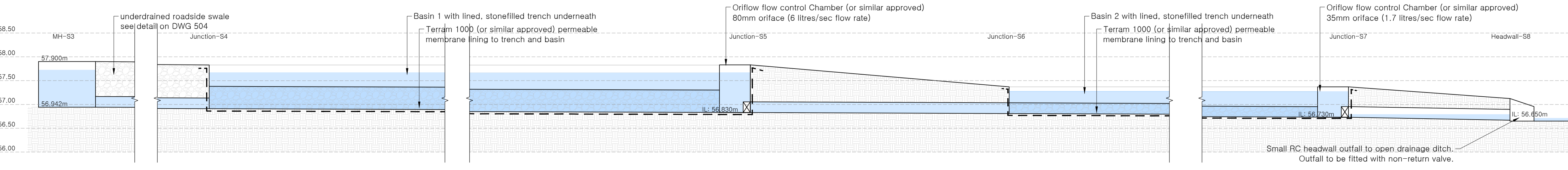

2 Basins - Longitudinal Section

1:50

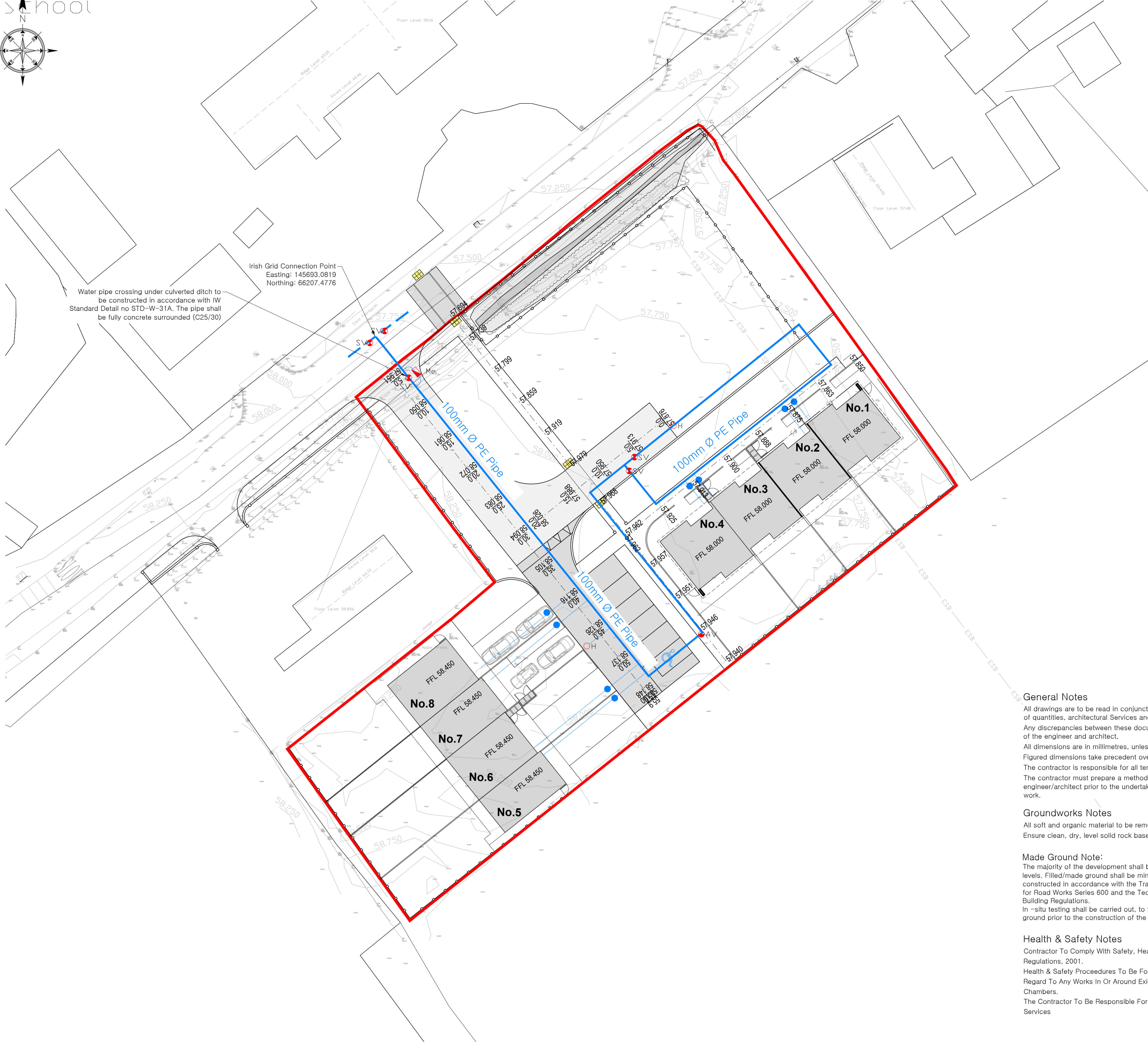
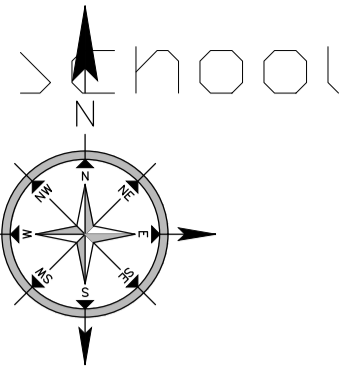

- Legend**
- Water service connection & boundary box (Refer to STD-W-01 & 03)
 - Water Main (80PE 100mm Ø unless otherwise shown - Refer to STD-W-13 re, Trenching & Backfilling)
 - Existing Watermain
 - AV Air Valve (Refer to STD-W-22 & 23)
 - H Hydrant (Refer to STD-W-18 & 19)
 - SV Sluice Valve (Refer to STD-W-15)
 - Me Bypass Flow Meter (Refer to STD-W-26F) (Developments with < 20m³/day demand)
 - Application Boundary

- See the following accompanying WDG drawings for watermain details:
- Irish Water Standard Details - Watermain Sheet 1 of 2 24004-XX-XX-XX-DR-WDG-CE-502.
 - Irish Water Standard Details - Watermain Sheet 2 of 2 24004-XX-XX-XX-DR-WDG-CE-503.

- NOTES:**
1. Do not Scale from the drawing.
 2. All dimensions are in mm unless otherwise noted.
 3. All coordinates are ITM.
 4. All construction details and domestic connections will be constructed to the specifications provided in the Irish Water Document: 'Water Infrastructure Standard Details - Connection and Developer Services. Document Number IW-CDS-5020-01. (December 2017, Revision 03) and the Irish Water Publication 'Code of Practice for Water Infrastructure', IW-CDS-5020-03 (December 2017, Revision 1).
 5. All water mains shall be blue MDPE or HDPE and of a type PE80 (Polyethylene) and have an SDR-11 or SDR-17 rating. They will conform to IS EN 12201: Part 1 and Part 2 (Plastic Systems for Water Supply, Drainage and Sewerage Under Pressure - Part 1, General and Part 2, Pipes) and IS EN 12201-3 (Plastic Systems for Water Supply, Drainage and Sewerage Under Pressure - Part 3: Fittings).
 6. Polyethylene pipes shall also conform to the following UK Water industry specifications (WIS): 4-32-08, 4-32-19 & IGN 4-32-18, 4-01-03.
 7. Polyethylene pipes shall also conform to the specifications in Section 3.3 of the Irish Water Code of Practice for Water Infrastructure, July 2020 (Rev 2).
 8. All water mains shall comply with Section 3.11 of IW-CDS-5020-03 regarding depth of cover.
 9. Air valve and hydrant covers, in grassed areas, shall be surrounded by a concrete plinth, 200mm all round and 100mm deep formed with C20/25 concrete, 20mm aggregate, bedded in clause 804 material. The plinth shall incorporate mild steel reinforcement links and have a bull-nose finish around its external perimeter. See section 3.18 of the Water Code of Practice.
 10. No hydrant has been located within 6m of a property as per section 3.5.25 of the Water Code of Practice.
 11. No new water main, up to and including 150mm Ø, has been located within 3m of an existing or proposed structure. See section 3.5.9 of the Water Code of Practice.
 12. Sluice valves have been placed at all junctions in accordance with sections 3.16.2 and 3.5.39 of the Water Code of Practice.
 13. Air valves shall be positioned at localised high points as shown on the drawing and in accordance with the Water Code of Practice.
 14. All 'T' Junctions will be made at 90° - see Irish Water standard detail STD-W-07.
 15. All water main construction shall be in compliance with the following Irish Water Documents: Code of Practice for Water Infrastructure, IW-CDS-5020-03, July 2020 (Rev 2) Water Infrastructure Standard Details, IW-CDS-5020-01, July 2020 (Rev 4)

General Notes
 All drawings are to be read in conjunction with all relevant specifications, bills of quantities, architectural Services and engineering drawings.
 Any discrepancies between these documents shall be brought to the attention of the engineer and architect.
 All dimensions are in millimetres, unless noted otherwise.
 Figured dimensions take precedent over scaled dimensions.
 The contractor is responsible for all temporary works.
 The contractor must prepare a method statement and submit it to the engineer/architect prior to the undertaking of any structural or civil engineering work.

Groundworks Notes
 All soft and organic material to be removed from under foundations.
 Ensure clean, dry, level solid rock base to all footings.

Made Ground Note:
 The majority of the development shall be constructed on or near existing ground levels. Filled/made ground shall be minimal and any made ground shall be constructed in accordance with the Transport Infrastructure Ireland Specification for Road Works Series 600 and the Technical Guidance documents of the Irish Building Regulations.
 In-situ testing shall be carried out, to the satisfaction of Irish Water, on the made ground prior to the construction of the wastewater and water supply networks.

Health & Safety Notes
 Contractor To Comply With Safety, Health And Welfare At Work (Construction) Regulations, 2001.
 Health & Safety Procedures To Be Followed At All Times, Especially With Regard To Any Works In Or Around Existing Live Sewers, Drains Or Inspection Chambers.
 The Contractor To Be Responsible For Checking The Location Of All Existing Services

1 Watermain Site Layout

Scale: 1:250

Note: It is the responsibility of the main contractor (Builder under the BCAR) to ensure that all work is completed in accordance with the Building Regulations & the latest relevant Technical Guidance Documents.

2	Issued For Planning	15/04/24	JP	IR
1	Alterations for IW	10/04/24	JP	MW
0	Issued for tender	02/04/24	JP	MW
Rev.	Description	Date	By	Check

walsh design group

Consulting Engineers

The Mall, Maryborough Woods, Douglas, Cork

Tel: 021-4774940 email: info@wdg.ie

Title:	Site Layout Watermains
Project:	Proposed Residential Development Cloughdub, Co. Cork
ID No:	24004-XX-XX-XX-DR-WDG-003
Date:	Feb 2024
Drawn by:	JP
Scale:	1:250
Purpose:	P3 - Planning

© COPYRIGHT WALSH DESIGN GROUP, DOUGLAS, CORK
THIS DRAWING CANNOT BE REPRODUCED WITHOUT WRITTEN PERMISSION

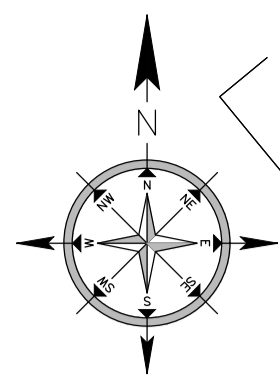

The existing open ditch shall be extended to remove the current field entrance. Otherwise the ditch shall be cleaned and the banks shall be maintained in their current profile. The base shall be lined with coarse washed 75/100mm crushed limestone.

F-EX
CL: 58.17
IL: 56.000

F-EX
CL: 57.370
IL: 55.550

F4
CL: 57.879
IL: 55.766

MH-S2
CL: 58.00
IL: 57.025

Junction-S5
Basin IL: 57.300, CL: 57.750
80mm Oriface IL: 56.830
Trench IL: 56.830

Junction-S4
Basin IL: 57.380, CL: 57.830
Inlet IL: 56.910
Trench IL: 56.910

MH-S3
CL: 57.90
IL: 56.942

F3
CL: 58.059
IL: 56.404

F2
CL: 58.167
IL: 57.117

MH-S1
CL: 57.933
IL: 57.017

S8 (Headwall)
IL: 56.670

Junction-S7
Basin IL: 56.950, CL: 57.300
35mm Ø Oriface IL: 56.730
Trench IL: 56.730

Detention Basin 2
Base area = 36m²
Top Area = 105m²
Depth = 0.35m, Side Slope = 1:4

Junction-S6
Basin IL: 57.020, CL: 57.370
Inlet IL: 56.810
Trench IL: 56.810

Detention Basin 1
Base area = 24m²
Top Area = 106m²
Depth = 0.45m, Side Slope = 1:3

No.1
FFL 58.000

No.2
FFL 58.000

No.3
FFL 58.000

No.4
FFL 58.000

No.8
FFL 58.450

No.7
FFL 58.450

No.6
FFL 58.450

No.5
FFL 58.450

Legend

- Roadside Filter Drains (225mm Ø slotted uPVC pipes surrounded in washed drainage zone and terram geotextile) – For details see WDG drawing no. 24004-XX-XX-XX-DR-WDG-CE-504
- Permeable Paving – Overflows connected to the main surface water network – For details see WDG drawing no. 23028-XX-XX-XX-DR-WDG-CE-504
- Raingardens over terram 1000 lined, stone filled soakaway pits (pits measure 1.5m x 1.5m x 1.0m deep – see detail below)
- Roadside Bioretention Tree Pits – overflows connected to the main surface network – For details see WDG drawing no. 24004-XX-XX-XX-DR-WDG-CE-504
- 300 Litre Water Butts
- Application Boundary

NOTES:

General Notes

All drawings are to be read in conjunction with all relevant specifications, bills of quantities, architectural Services and engineering drawings.
Any discrepancies between these documents shall be brought to the attention of the engineer and architect.
All dimensions are in millimetres, unless noted otherwise.
Figured dimensions take precedent over scaled dimensions.
The contractor is responsible for all temporary works.
The contractor must prepare a method statement and submit it to the engineer/architect prior to the undertaking of any structural or civil engineering work.

Groundworks Notes

All soft and organic material to be removed from under foundations.
Ensure clean, dry, level solid rock base to all footings.

Services Notes

All new drainage pipes up to and including 1500 to be uPVC to BS EN 1401-01, unless otherwise noted.
All internal pipes to be provided with 100mm thick mass concrete bed.
Manholes to be constructed using precast manhole rings, unless noted otherwise.

Health & Safety Notes

Contractor To Comply With Safety, Health And Welfare At Work (Construction) Regulations, 2001.
Health & Safety Procedures To Be Followed At All Times, Especially With Regard To Any Works In Or Around Existing Live Sewers, Drains Or Inspection Chambers.
The Contractor To Be Responsible For Checking The Location Of All Existing Services

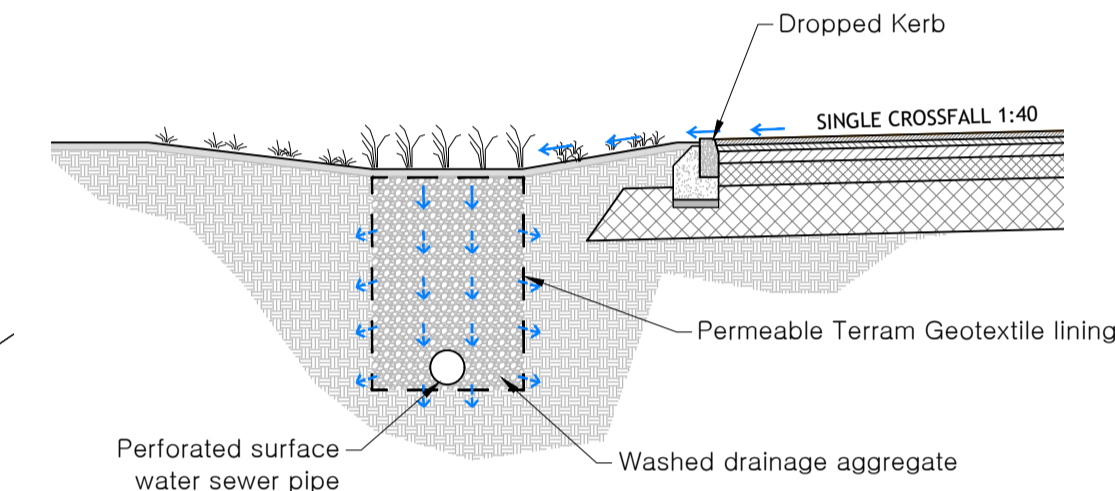

2 Roadside Filter Drain

Scale: 1:50



Roadside Bioretention Tree Pits



300 litre water butt with overflow to be installed to the rear of all dwellings in private back gardens

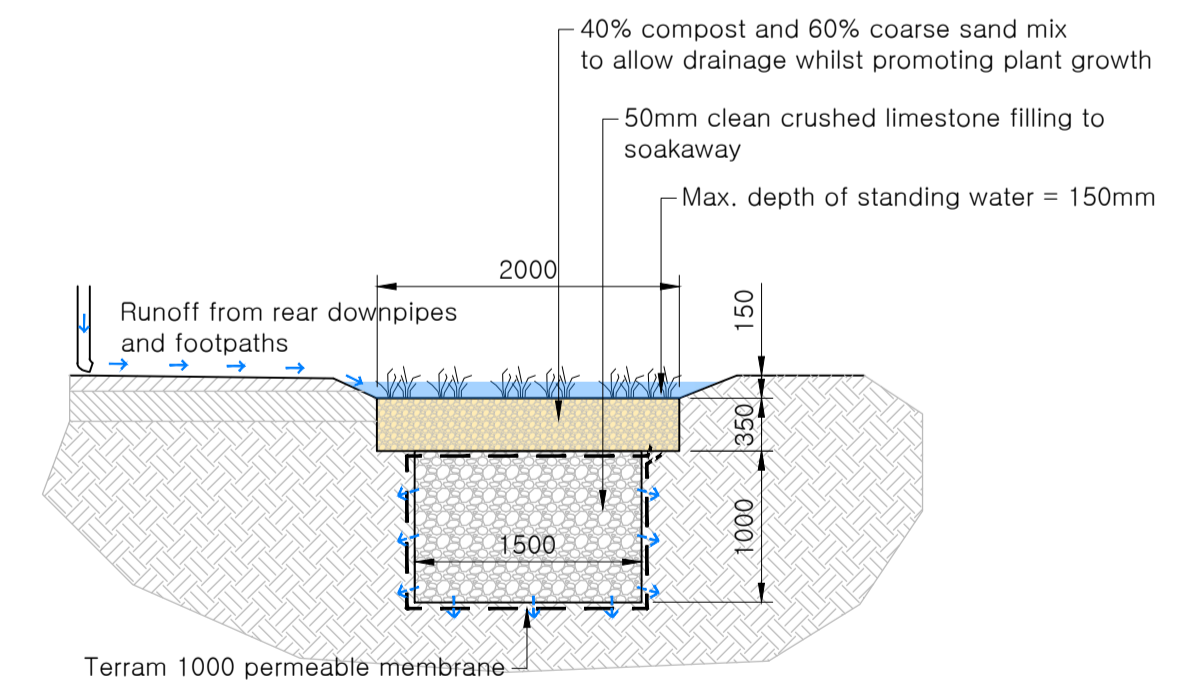

3 Rain Garden Soakaway

Scale: 1:50

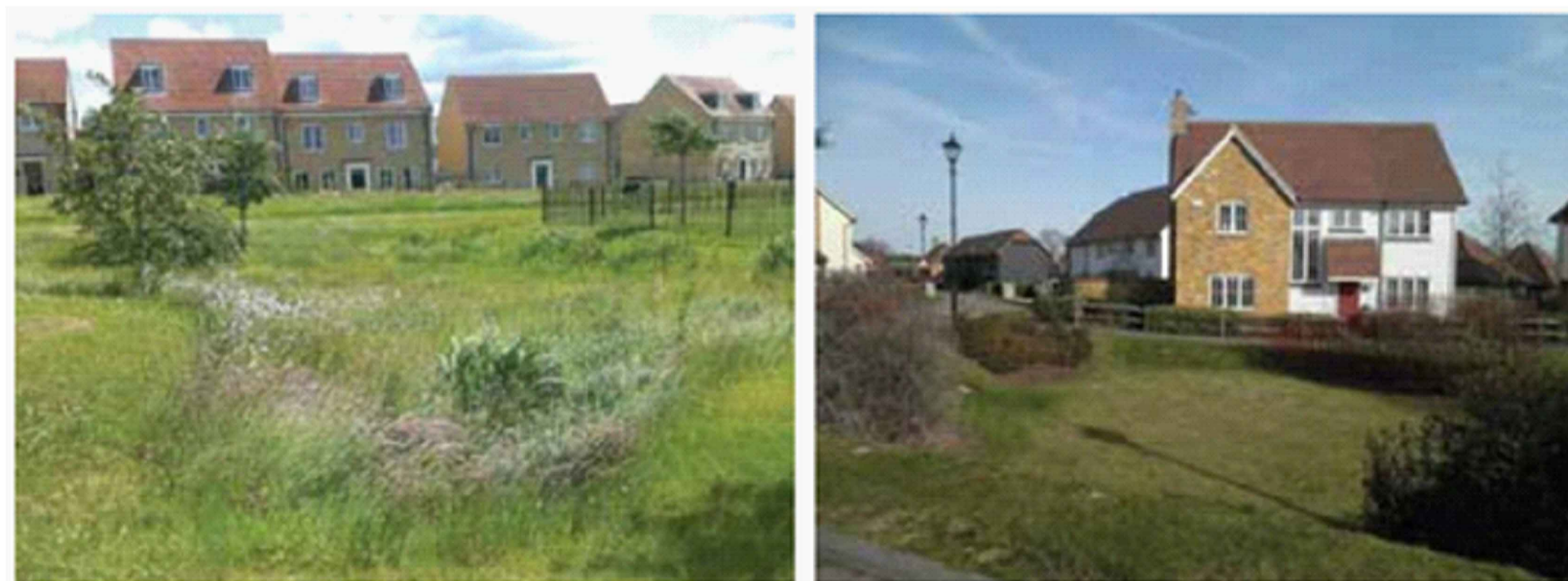

Shallow Detention Basins (Examples)

1 Proposed SuDs Layout

Scale: 1:200

2	Issued For Planning	15.04.24	JP	MR
0	Issued for tender	02.04.24	JP	MR
1	Revised	12.04.24	JP	MR

walsh design group
NSAI
Consulting Engineers
The Mall, Maryborough Woods, Douglas, Cork
Tel: 021-4774940 email: info@wdg.ie

Title:	Site Layout Proposed SuDs Features
Project:	Proposed Residential Development Cloughdub, Co. Cork

ID No:	24004-XX-XX-XX-DR-WDG-005	Rev:	2
Date:	Feb 2024		
Drawn by:	JP		
Scale:	1:200		
Purpose:	P3-Planning		

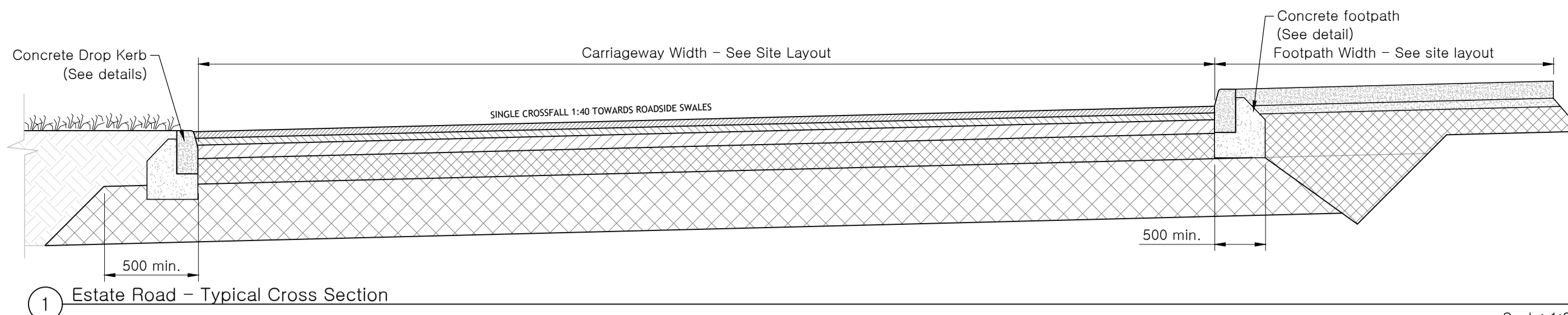

1 Estate Road - Typical Cross Section

Scale: 1:25

Standard Estate Road Construction
 40mm STONE MASTIC ASPHALT (SMA) OR DENSE WEARING COURSE MACADAM (DWC) - AGGREGATE NOM. SIZE 14mm. (EITHER SMA OR DWC SHALL COMPLY WITH TII SPECIFICATION FOR ROADWORKS) ON TACK COAT ON
 40mm BITUMINOUS BASE (BINDER) COURSE TO COMPLY WITH THE TII SPECIFICATION FOR ROADWORKS ON
 80mm DENSE BITUMEN MACADAM ROADBASE TO COMPLY WITH THE TII SPECIFICATION FOR ROADWORKS ON
 150mm TYPE B MATERIAL TO CLAUSE 804 & CLAUSE 808 (TII PUBLICATIONS, PUBLICATION NUMBER CC-SPW-00800, MARCH 2013) UNBOUND SUB-BASE ON
 300-600mm CLASS 6F2 MATERIAL CAPPING LAYER ON
 CLASS 6C STARTER LAYER MATERIAL (WHERE REQUIRED TO RAISE LEVELS) GRADED IN ACCORDANCE WITH TABLE 6/2 AND COMPACTED IN ACCORDANCE WITH TABLE 6/4 OF THE TII SPECIFICATION FOR ROADWORKS CC-SPW-00600.
 (The depth of the Capping layer depends on CBR tests carried out on the Subgrade at 50m ctrs. by the contractor - please inform the Engineer of CBR results as soon as they are available)

Coloured Estate Road Construction
 40mm STONE MASTIC ASPHALT (SMA) OR DENSE WEARING COURSE MACADAM (DWC) - AGGREGATE NOM. SIZE 14mm. (EITHER SMA OR DWC SHALL COMPLY WITH TII SPECIFICATION FOR ROADWORKS) WITH ADDED BEIGE COLOURED CHIPPINGS ON TACK COAT ON
 40mm BITUMINOUS BASE (BINDER) COURSE TO COMPLY WITH THE TII SPECIFICATION FOR ROADWORKS ON
 80mm DENSE BITUMEN MACADAM ROADBASE TO COMPLY WITH THE TII SPECIFICATION FOR ROADWORKS ON
 150mm TYPE B MATERIAL TO CLAUSE 804 & CLAUSE 808 (TII PUBLICATIONS, PUBLICATION NUMBER CC-SPW-00800, MARCH 2013) UNBOUND SUB-BASE ON
 300-600mm CLASS 6F2 MATERIAL CAPPING LAYER ON
 CLASS 6C STARTER LAYER MATERIAL (WHERE REQUIRED TO RAISE LEVELS) GRADED IN ACCORDANCE WITH TABLE 6/2 AND COMPACTED IN ACCORDANCE WITH TABLE 6/4 OF THE TII SPECIFICATION FOR ROADWORKS CC-SPW-00600.
 (The depth of the Capping layer depends on CBR tests carried out on the Subgrade at 50m ctrs. by the contractor - please inform the Engineer of CBR results as soon as they are available)

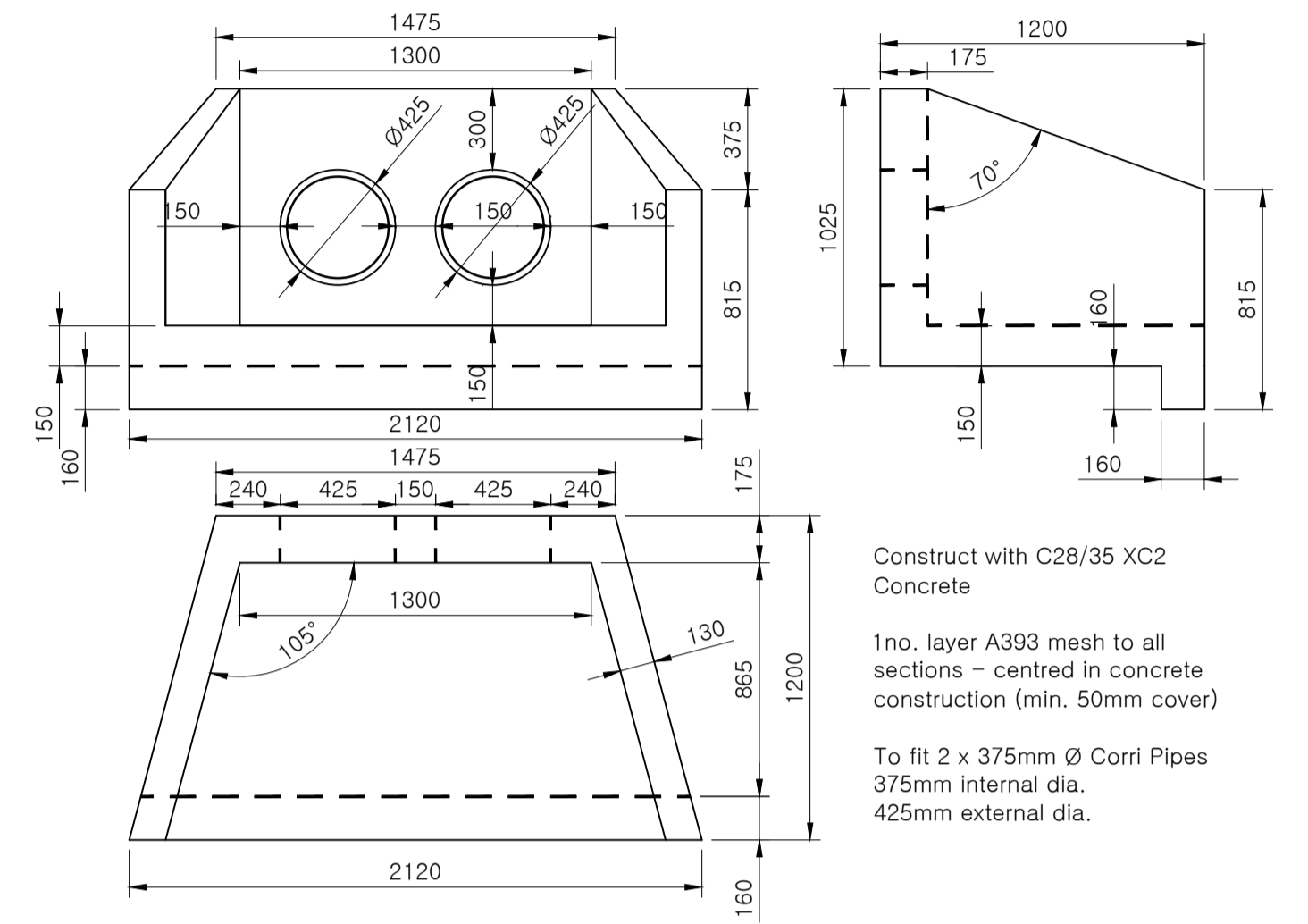

2 Double Pipe Headwall (Both sides of new entrance)

Scale: 1:25

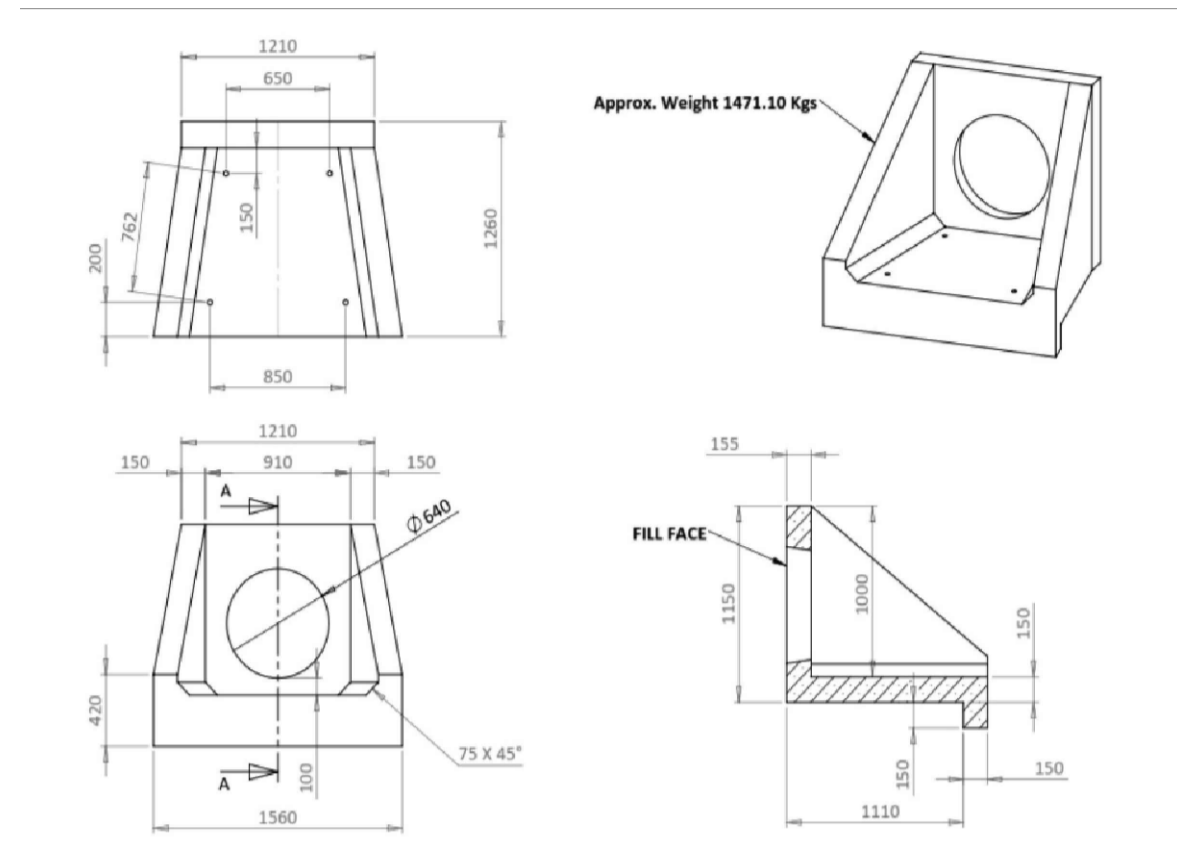

3 Small RC Headwall Detail (Outfall to Ditch)

Scale: NTS

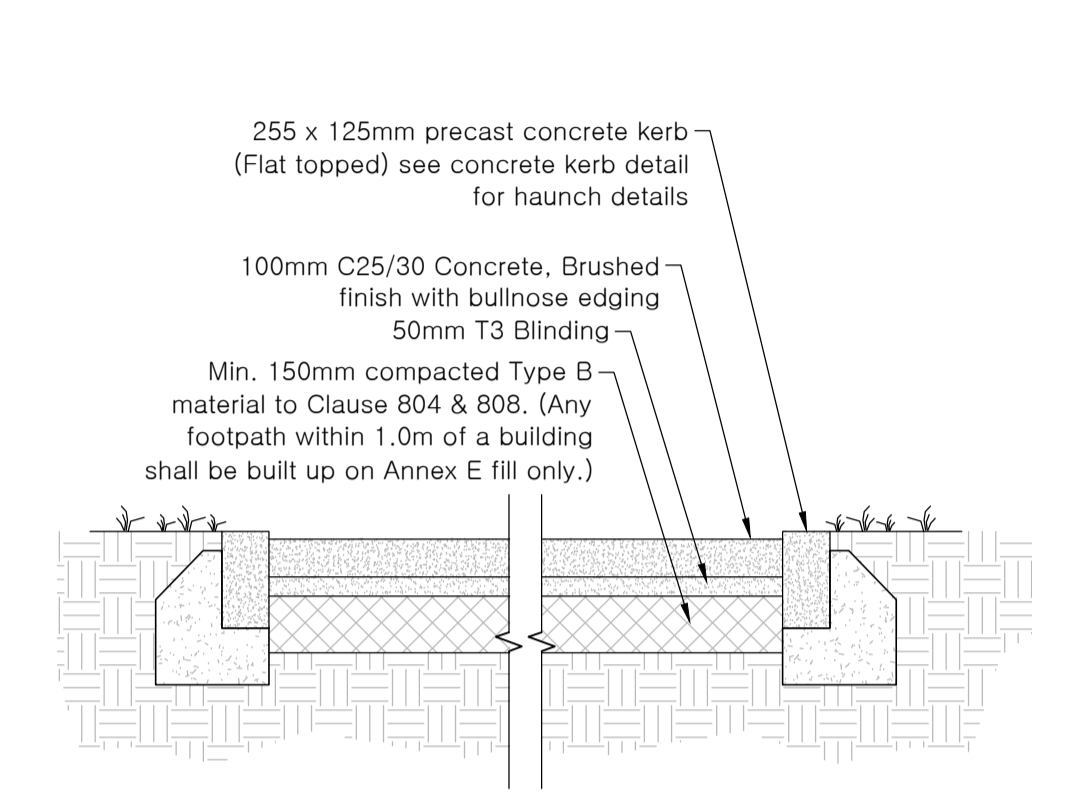

4 Public non-roadside Footpath - Typical Cross Section

Scale: 1:20

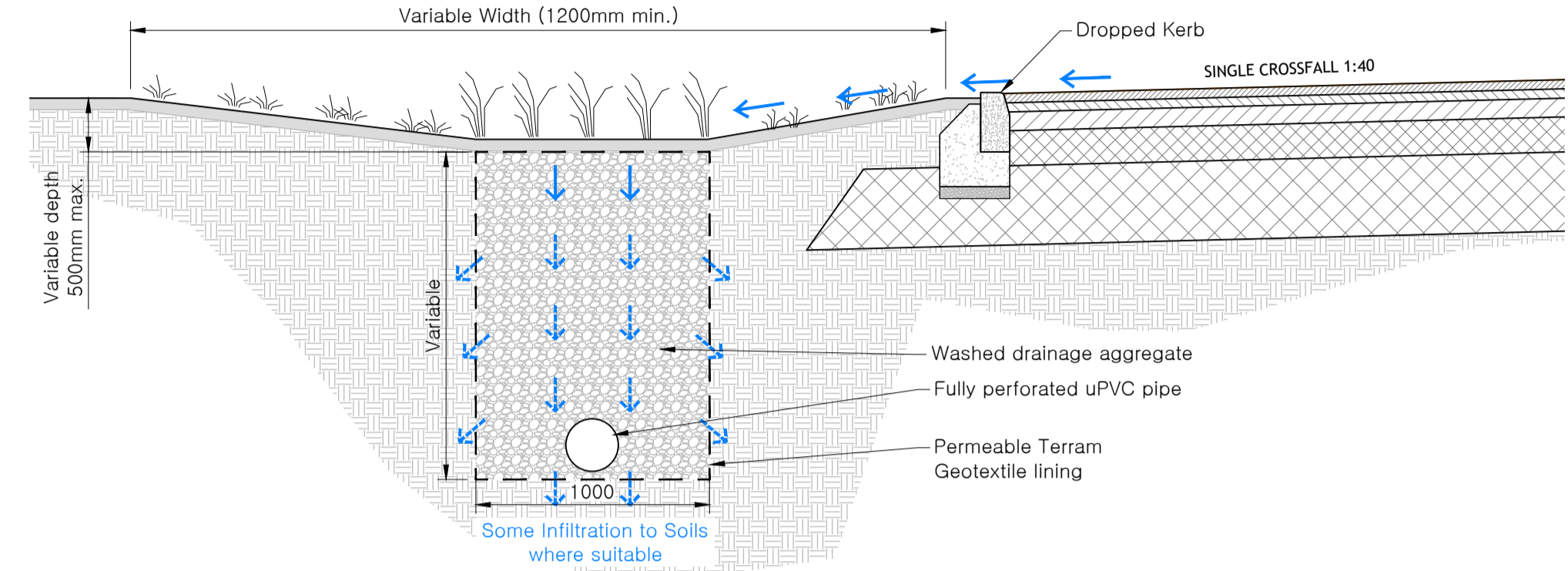

5 Underdrained Linear Roadside Swale

Scale: 1:25

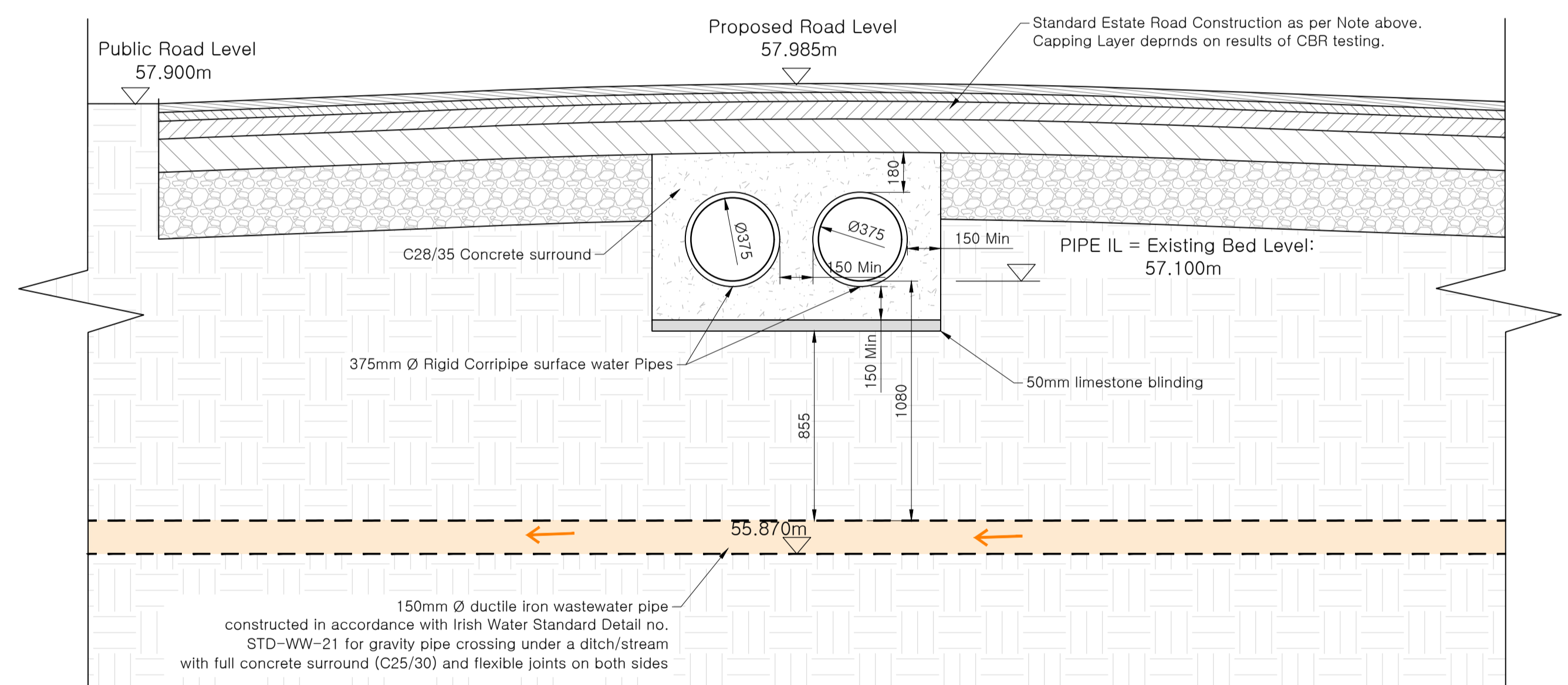

6 Proposed Culvert of Existing Ditch under new development entrance

Scale: 1:20

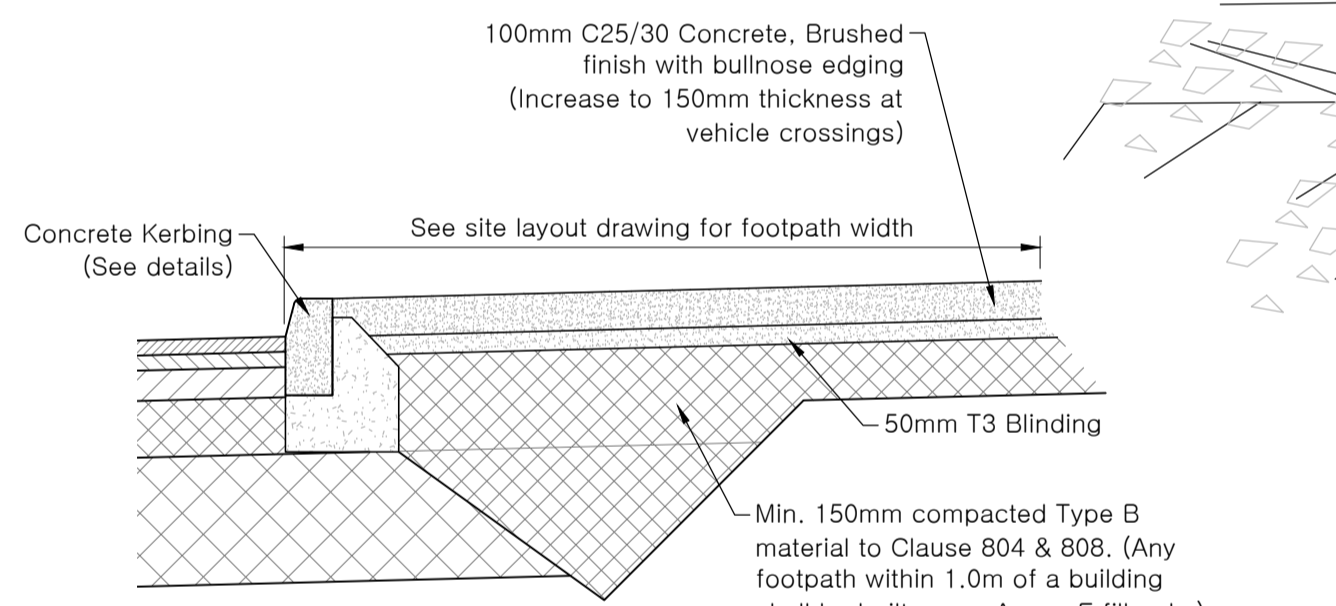

7 Public roadside Footpath - Typical Cross Section

Scale: 1:20

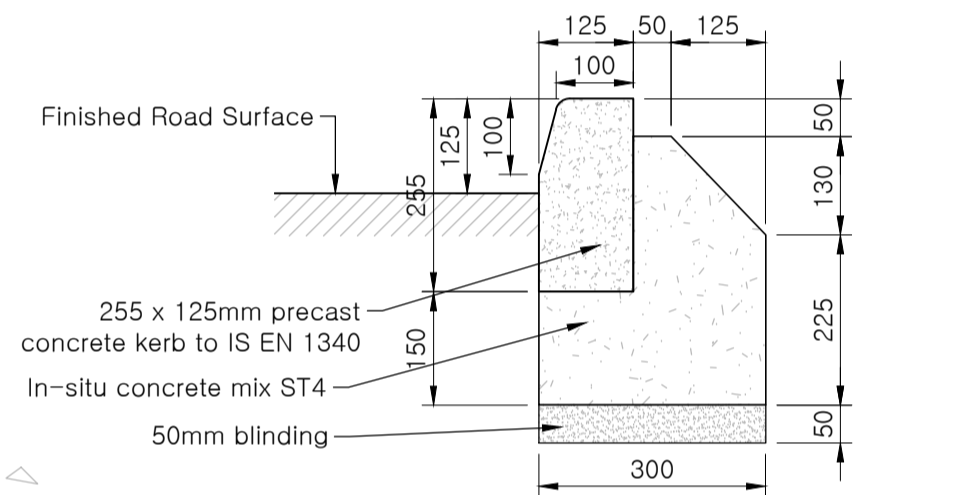

8 Concrete Kerb Detail

Scale: 1:10

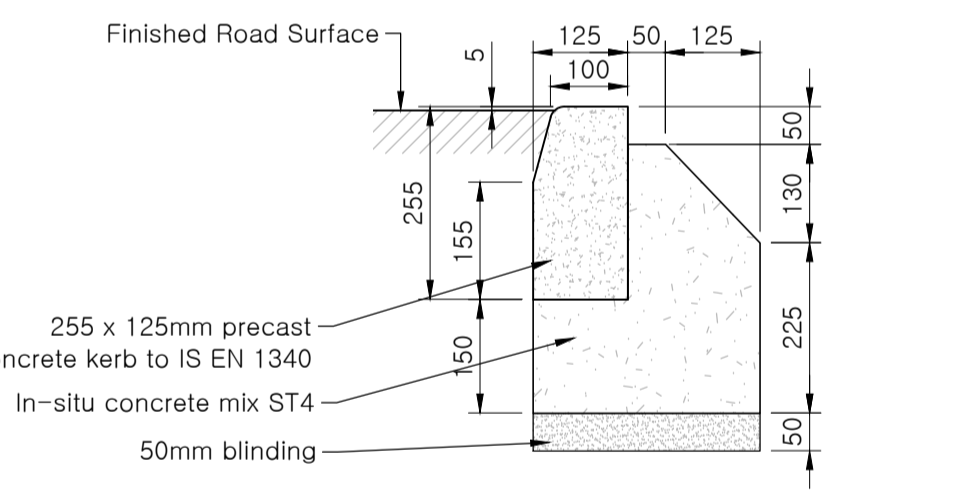

9 Drop Kerb Detail

Scale: 1:10

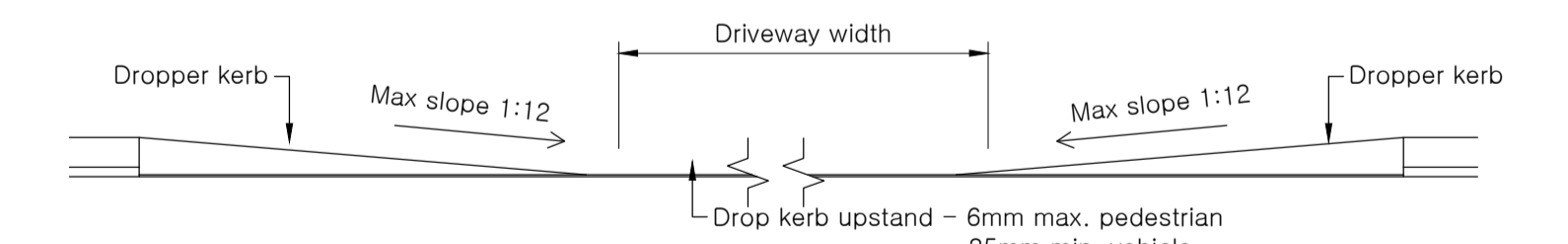

10 Typical Elevation of Ramps at Drop Kerbs

Scale: 1:25

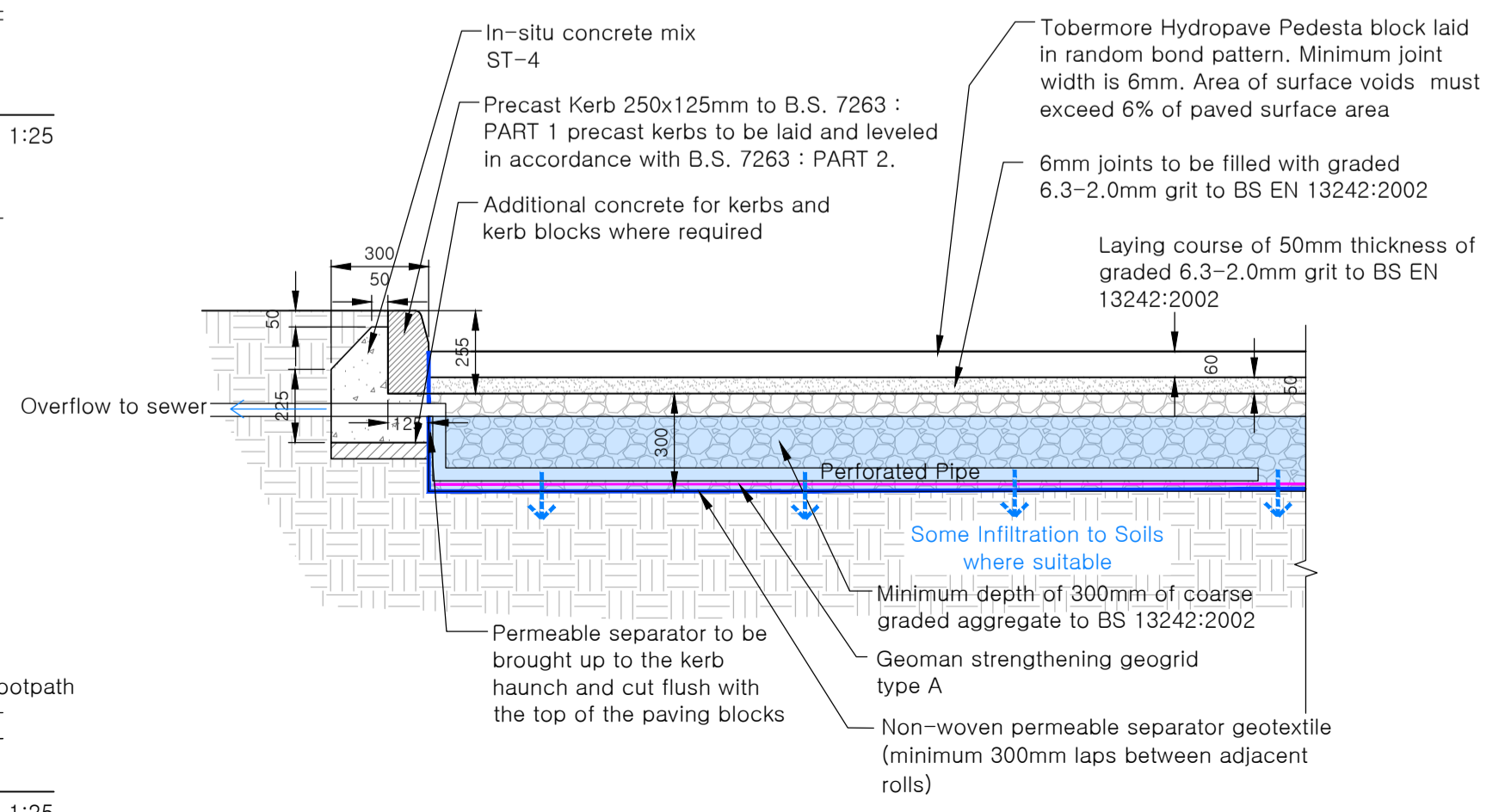

12 Permeable Paving Details (Private Driveways & Paths)

Scale: 1:20

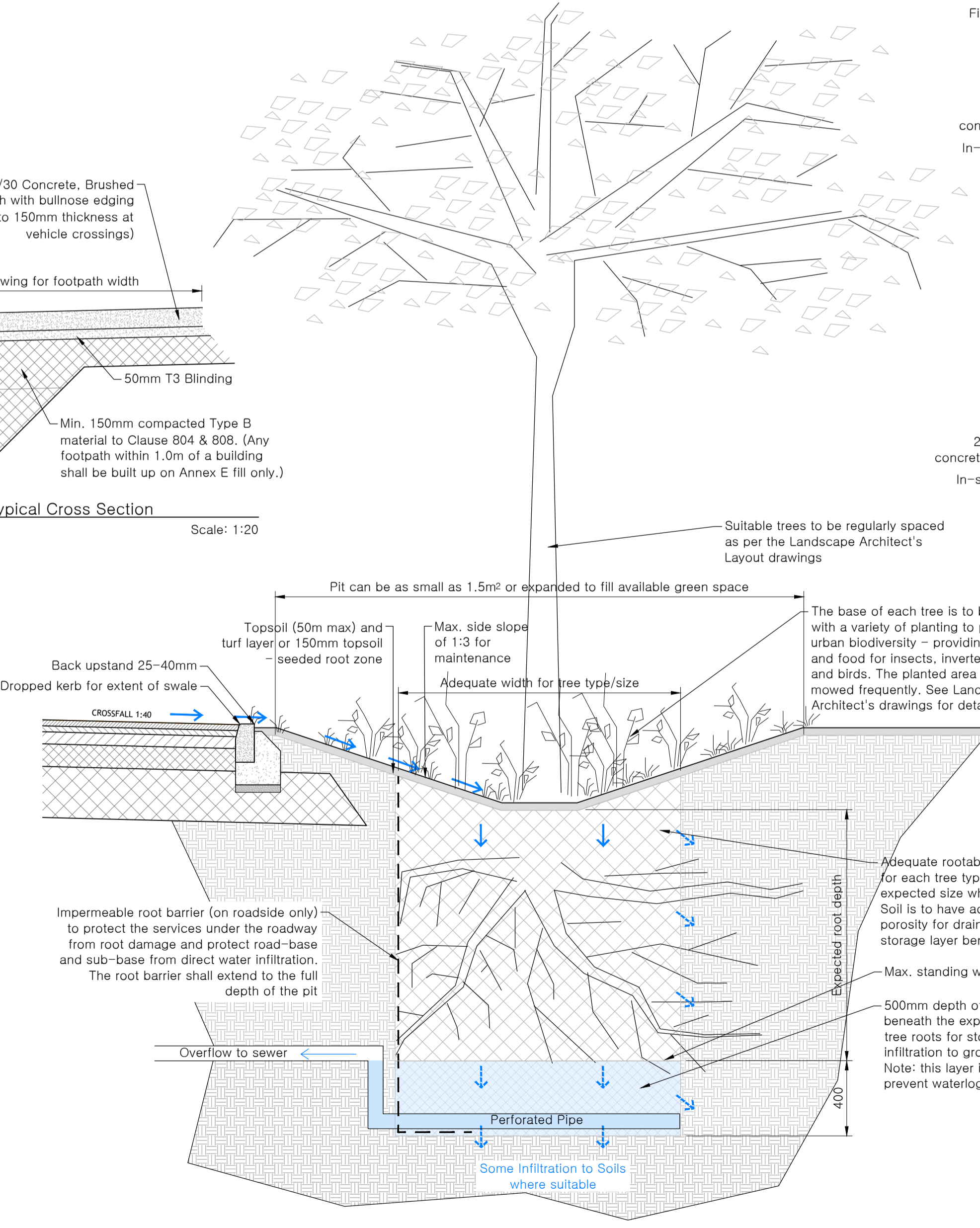

13 Roadside Bioretention Tree Pit

Scale: 1:25

Note: It is the responsibility of the main contractor (Builder under the BCAR) to ensure that all work is completed in accordance with the Building Regulations & the latest relevant Technical Guidance Documents.

Rev.	Description	Date	By	Check
2	Issued For Planning	15.04.24	JP	RP
1	Issued For tender	02/04/24	JP	RP
0	Issue / Description	12.02.24	JP	RP

walsh design group
 Consulting Engineers
 The Mall, Maryborough Woods, Douglas, Cork
 Tel: 021-4774940 email: info@wdg.ie

Title:	Construction Details
Project:	Proposed Residential Development Cloughdub Co.Cork
ID No:	24004-XX-XX-XX-DR-WDG-CE-504
Date:	FEB 2024
Drawn by:	JP
Scale:	As Shown
Purpose:	P3-Planning
Rev:	2

Document Register

Project: **Proposed Housing Development, Cloughduv, Co.Cork**

WDG Job No.: 24004
Project ID: 24004

Document ID	Title	Date of Issue											
		Day	14	4	15	2	3	8	10	15	15		
		Month	2	3	3	4	4	4	4	4	4		
		Year	24	24	24	24	24	24	24	24	24		
	%	1	2	3	4	5	6	7	8	9			
Drawings													
24004-XX-XX-XX-DR-WDG-CE-001	Site Layout - Roads & Levels		0	1	0					2			
24004-XX-XX-XX-DR-WDG-CE-002	Site Layout - Drainage		0	1	0			1		2			
24004-XX-XX-XX-DR-WDG-CE-003	Site Layout - Watermains		0	1	0			1	0	2			
24004-XX-XX-XX-DR-WDG-CE-005	Site Layout - Proposed SuDS Features		0	1	0	0				2			
24004-XX-XX-XX-DR-WDG-CE-006	Site Layout - Phase 2 Drainage				0								
24004-XX-XX-XX-DR-WDG-CE-007	Site Layout - Phase 2 Watermains				0								
24004-XX-XX-XX-DR-WDG-CE-500	Surface Water Drainage Typical Details		0		0								
24004-XX-XX-XX-DR-WDG-CE-501	Irish Water Standard Details - Wastewater		0		0								
24004-XX-XX-XX-DR-WDG-CE-502	Irish Water Standard Details - Water Main (Sheet 1 of 2)		0		0								
24004-XX-XX-XX-DR-WDG-CE-503	Irish Water Standard Details - Water Main (Sheet 2 of 2)		0		0								
24004-XX-XX-XX-DR-WDG-CE-504	Construction Details		0	1	0					2			
24004-XX-XX-XX-DR-WDG-CE-900	Phase 1 Site Boundary Map												
24004-XX-XX-XX-DR-WDG-CE-901	Phase 2 Site Boundary Map				0								
24004-XX-XX-XX-DR-WDG-CE-902	Boundary Treatments 1 of 2					0	0						
24004-XX-XX-XX-DR-WDG-CE-903	Boundary Treatments 2 of 2					0	0						
Reports													
24004-XX-XX-XX-RP-WDG-CE-001	Civil Engineering Report		0	1	0				0				
24004-XX-XX-XX-SP-WDG-CE-001	External Works Specification						0						
Distribution		"N" of Hard Copies		E = Email Issue		C = Common Data Environment							
Client		C	C		C	C	C	C	C	C			
Architect		C	C		C	C	C	C	C	C			
Project Managers													
Civil / Structural Consultant													
Planning Consultant		C	C		C	C	C	C	C	C			
Consulting Engineers		C	C		C	C	C	C	C	C			
Main Contractor													
Irish Water					E								
Local Authority													
Quantity Surveyor		C	C		C	C	C	C	C	C			
Purpose of Issue													
P1 - Information				X									
P2 - Coordination													
P3 - Planning Permission		X	X							X			
P4 - Fire Safety Cert Application													
P5 - Disability Access Cert Application													
P6 - Building Control Compliance													
P7 - Pre-Tender													
P8 - Tender					X	X	X	X	X				
P9 - Contract / Construction													
P10 - Handover													
P11 - Other													
Issued by:		IR	IR	JD	IR	MF	MF	IR	MF	JD			