

LEGEND:
 — = Site Boundary
 Site Area = 0.094 ha
 Note: Spot Levels Denote Existing Levels

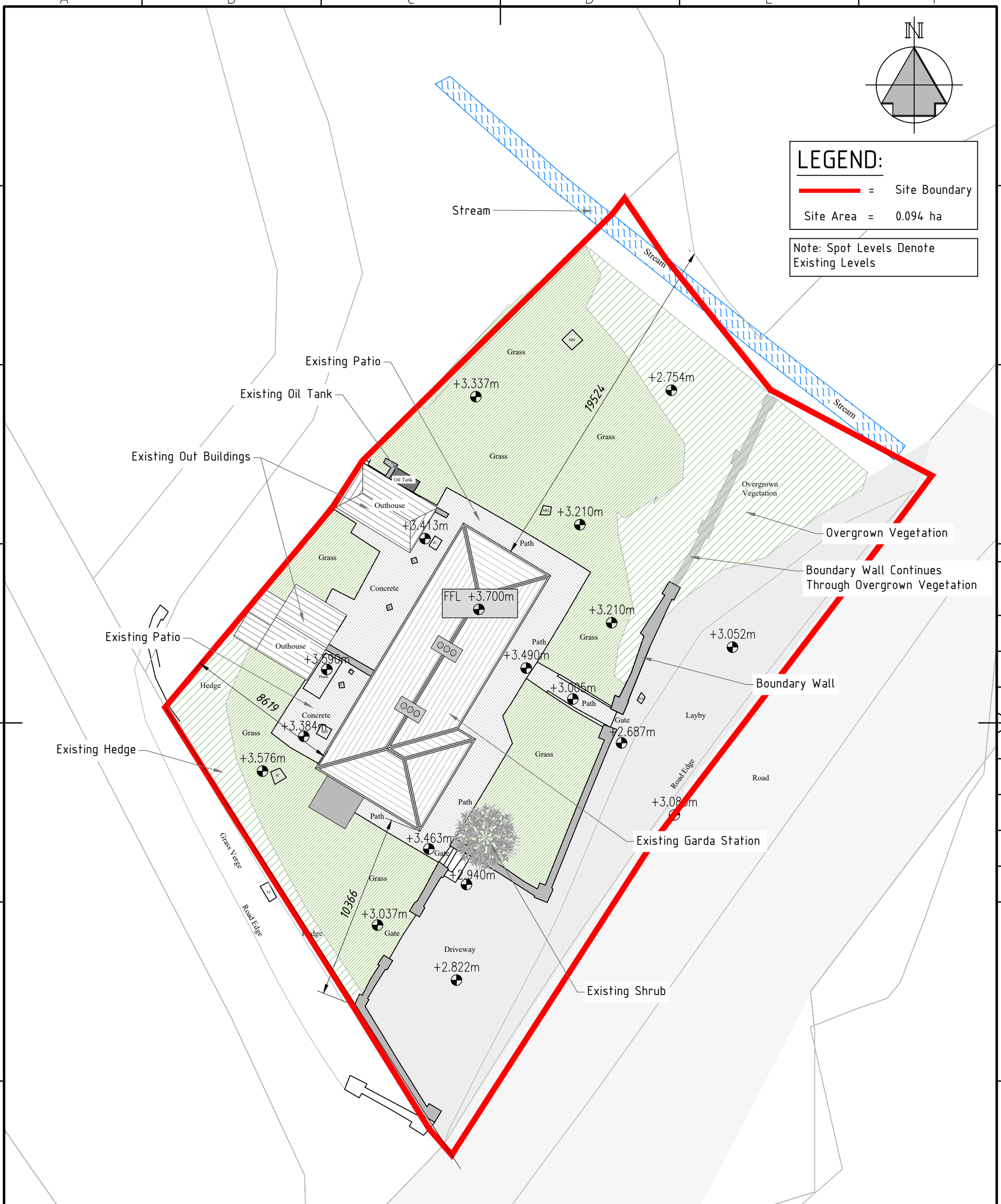

1	07/24	CF	Issue 1
0	03/24	DOS	Issue 0
REVISION	DATE	BY	DETAILS

<p>THIS DRAWING IS COPYRIGHT Dimensions are in mm except where indicated. Figured dimensions take precedence over scaled measurements. All dimensions to be checked on site prior to fabrication or construction. All works to be in accordance with Current Building Regulations and Codes. (Sub)Contractors are responsible for ensuring compliance with Building Regulations within their Trade. Where this drawing is open to public inspection pursuant to a statutory requirement, or is on a statutory register, copying is subject to the requirements of Section 74 of the Copyright and Related Rights Act, 2000</p>	Drawn By DOS	Chkd By CC	Approved By CC	DWG Date 13/03/24	Scale 1/200 @A3	Purpose Code P03	Acceptance Code S	Rev. 1	Stage Planning	
	CroCon Engineers Ltd. Consulting Engineers 4 Main St., Bantry, Co. Cork E: info@crocon.ie Tel: (027) 50123					Project: 23004 - CRO - X - XXX - DR - SE - 01000 Client: Cork County Council Project: Proposed 2 No. Houses, Adrigole Garda Station, Co. Cork Title: Existing Site Layout				
				Originator CRO	Spatial Zone X	Level XXX	Info Type DR	Role SE	Number 01000	