

# Cork County Council



## R572 Glengarriff Footpaths Traffic Calming Measures

### ***Section 38***

**August 2024**

#### **Drawing Schedule**

<b>Drawing No.</b>	<b>Drawing Title</b>	<b>Rev.</b>	<b>Scale</b>	<b>Size</b>
R572-LM-01	Location Map	D0	NTS	A3
R572-LA-01,02,03	Proposed Layout Plan	D0	1:500	A3

**Regional & Local Roads  
Design Office**  
*Floor 3, County Library Building  
Carrigrohane Road, Cork, T12 K335*



Not to Scale

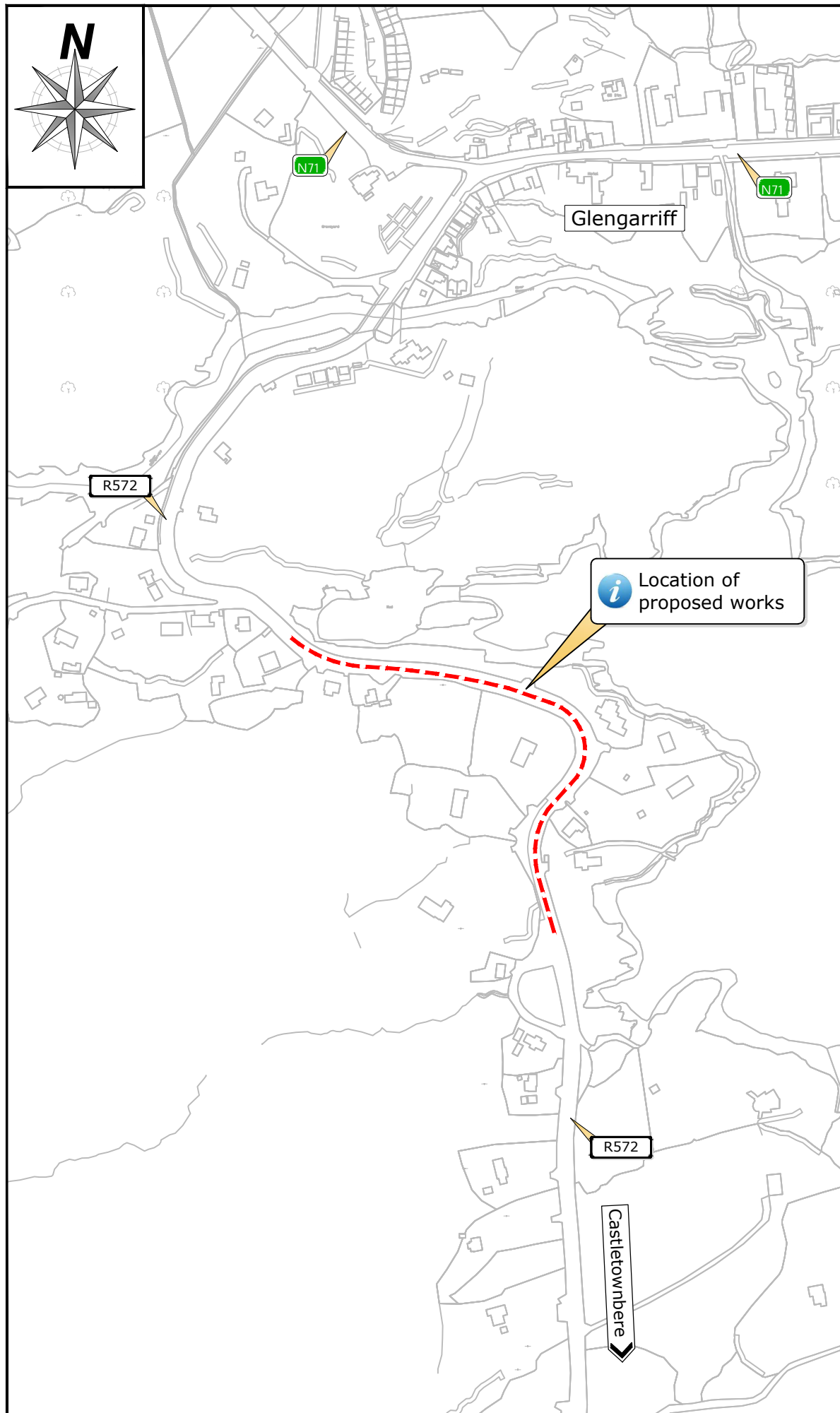

Not to Scale

Rev	By	Date	Description
D0	EF	August 2024	Section 38

© Copyright  
 The information on this drawing is confidential and must not be disclosed to any third party or reproduced, in whole or part, without the express written consent of Cork County Council. All drawings remain the property of Cork County Council.  
 Includes Ordnance Survey Ireland data reproduced under OSI Licence number 2010/2006 / CCMA / Cork County Council. Unauthorized reproduction infringes Ordnance Survey Ireland and Government of Ireland copyright. © Ordnance Survey Ireland, year 2014.

0m 10mm 20mm 30mm 40mm 50mm

**CORK COUNTY COUNCIL**  
 Regional & Local Roads Design Office  
 Floor 3  
 County Library Building  
 Carrigrohane Road, Cork.

Project:  
**R572 Glengarriff Footpaths**

Title:  
 Location Map

Scale:  
 1 August 2024

Sheet:  
 EF EF \*\* 03.05.2023 NTS A3  
 Section 38 R572-LM-01 D0

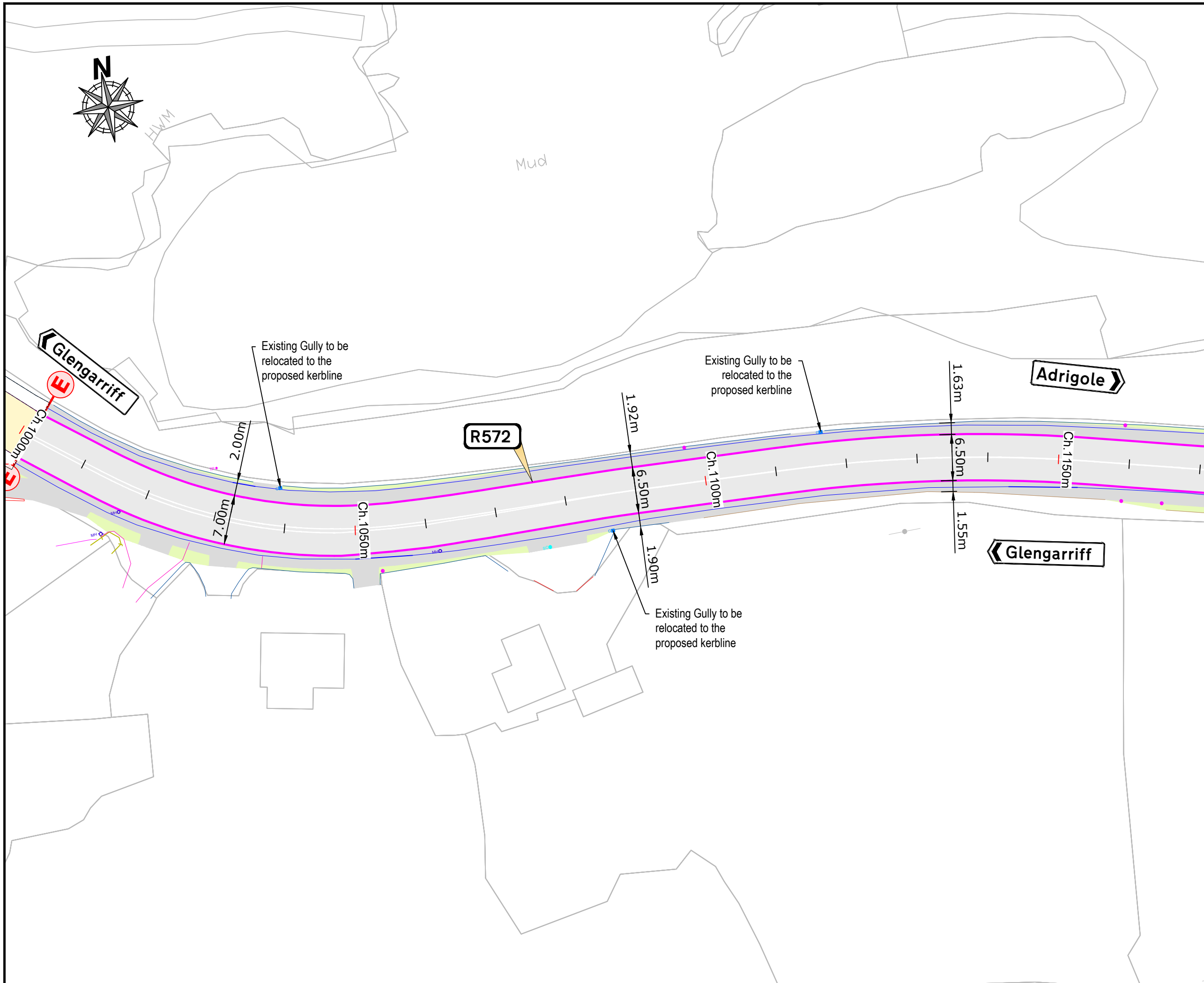



- NOTES**
- All dimensions in metres unless otherwise stated.
  - Any queries to be conveyed to the CCC Road Design Office, Floor 3, County Library Building.
  - Dimensions not to be scaled from drawing. Any queries to be conveyed to the CCC Road Design Office, Floor 3, County Library Building.
  - The information shown on this plan is a general guide and the accuracy thereof cannot be guaranteed. No liability is accepted for any discrepancy, omission or deviation and the actual position of services and underground plant must be established on site before any mechanical excavation is undertaken.

- LEGEND**
- Site Extents
  - Extent of proposed scheme
  - Existing road edge
  - Existing kerblines
  - Existing edge of footpath
  - Existing boundary wall
  - Existing road
  - Existing footpath
  - Existing green area
  - Proposed Standard Kerb as per TII CC-SCD-01101 Type A, 125mm from top of kerb to proposed carriageway level (Refer to drawing CC-SCD-01101)
  - Proposed carriageway
  - Proposed concrete footpath as per TII CC-SCD-01105 Type 1 (Refer to drawing CC-SCD-01105)
  - Proposed green area

Rev	By	Date	Description
A0	MD	03/07/2024	Preliminary

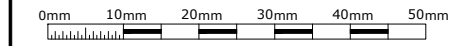
**© Copyright**  
 The information on this drawing is confidential and must not be disclosed to any third party or reproduced, in whole or part, without the express written consent of Cork County Council. All drawings remain the property of Cork County Council. Includes Ordnance Survey Ireland data reproduced under OSI Licence number 2024 / OSI\_NMA\_045 / Cork County Council. Unauthorised reproduction infringes Ordnance Survey Ireland and Government of Ireland copyright. © Ordnance Survey Ireland, year 2024.





**CORK COUNTY COUNCIL**  
 Regional & Local Roads Design Office  
 Floor 3  
 County Library Building  
 Carrigrohane Road, Cork, T12 K335.

**R572 GLENGARRIFF FOOTPATH**

**PROPOSED LAYOUTS**  
 Sheet 1 of 3

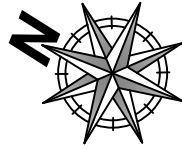
MD	MD	DOR	AP	19.07.2024	1:500	A3
19 July 2024						
<b>PRELIMINARY</b>						R572 - LA - 01
						A0



**NOTES**

- 1 All dimensions in metres unless otherwise stated.
- 2 Any queries to be conveyed to the CCC Road Design Office, Floor 3, County Library Building.
- 3 Dimensions not to be scaled from drawing. Any queries to be conveyed to the CCC Road Design Office, Floor 3, County Library Building.
- 4 The information shown on this plan is a general guide and the accuracy thereof cannot be guaranteed. No liability is accepted for any discrepancy, omission or deviation and the actual position of services and underground plant must be established on site before any mechanical excavation is undertaken.



**LEGEND**

- Site Extents
- Extent of proposed scheme
- Existing road edge
- Existing kerbline
- Existing edge of footpath
- Existing boundary wall
- Existing road
- Existing footpath
- Existing green area
- Proposed Standard Kerb as per TII CC-SCD-01101 Type A, 125mm from top of kerb to proposed carriageway level (Refer to drawing CC-SCD-01101)
- Proposed carriageway
- Proposed concrete footpath as per TII CC-SCD-01105 Type 1 (Refer to drawing CC-SCD-01105)
- Proposed green area

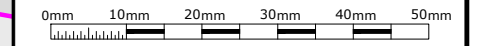

Rev	By	Date	Description
A0	MD	03/07/2024	Preliminary

**© Copyright**  
 The information on this drawing is confidential and must not be disclosed to any third party or reproduced, in whole or part, without the express written consent of Cork County Council. All drawings remain the property of Cork County Council. Includes Ordnance Survey Ireland data reproduced under OSI Licence number 2024 / OSI\_NMA\_045 / Cork County Council. Unauthorised reproduction infringes Ordnance Survey Ireland and Government of Ireland copyright. © Ordnance Survey Ireland, year 2024.





**CORK COUNTY COUNCIL**  
 Regional & Local Roads Design Office  
 Floor 3  
 County Library Building  
 Carrigrohane Road, Cork, T12 K335.

**R572 GLENGARRIFF FOOTPATH**

**PROPOSED LAYOUTS**  
 Sheet 2 of 3

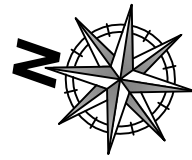
MD	MD	DOR	AP	19.07.2024	1:500	A3
19 July 2024						
<b>PRELIMINARY</b>						R572 - LA - 02
						A0



**NOTES**

- 1 All dimensions in metres unless otherwise stated.
- 2 Any queries to be conveyed to the CCC Road Design Office, Floor 3, County Library Building.
- 3 Dimensions not to be scaled from drawing. Any queries to be conveyed to the CCC Road Design Office, Floor 3, County Library Building.
- 4 The information shown on this plan is a general guide and the accuracy thereof cannot be guaranteed. No liability is accepted for any discrepancy, omission or deviation and the actual position of services and underground plant must be established on site before any mechanical excavation is undertaken.

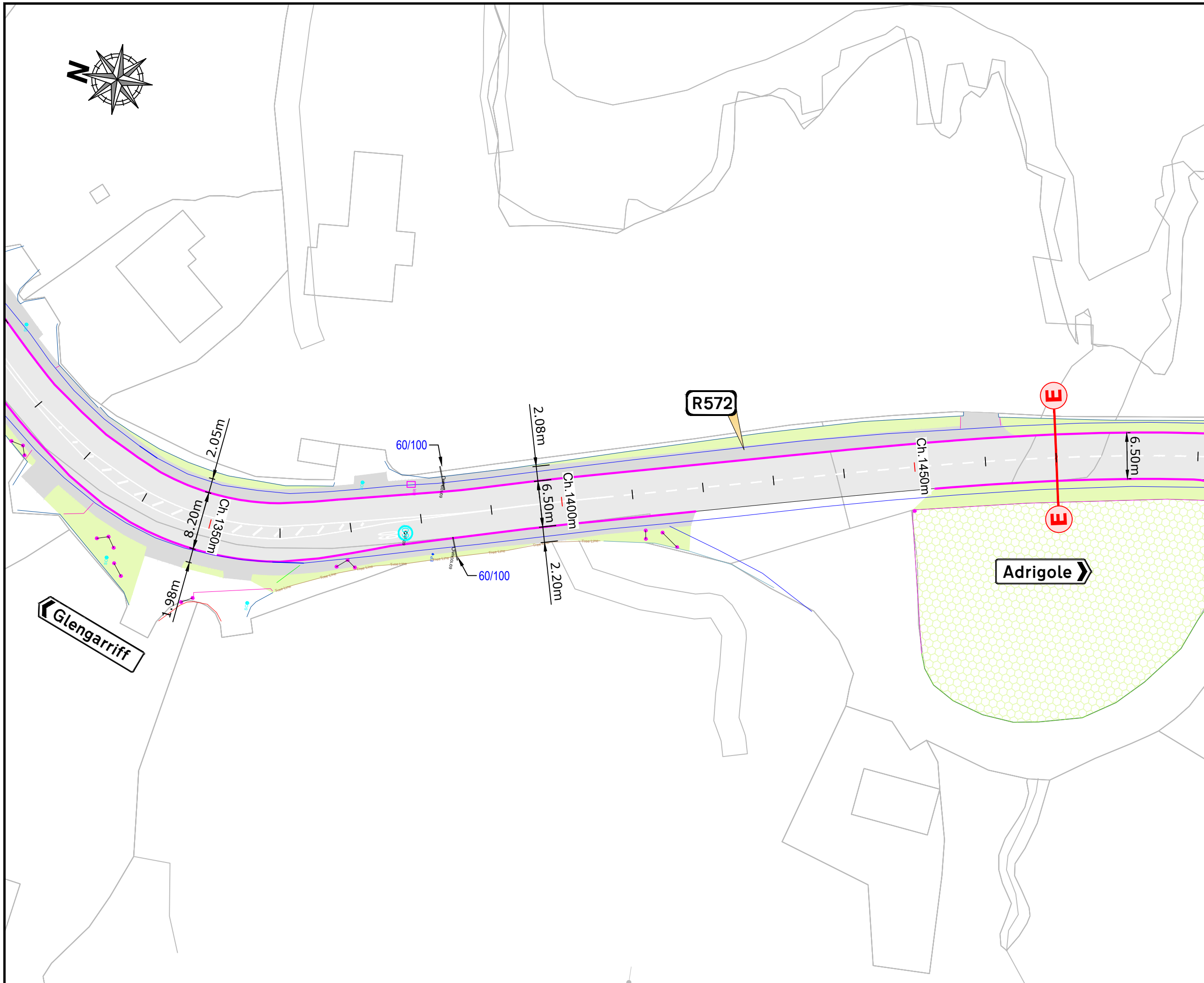

**LEGEND**

- Site Extents
- Extent of proposed scheme
- Existing road edge
- Existing kerline
- Existing edge of footpath
- Existing boundary wall
- Existing road
- Existing footpath
- Existing green area
- Proposed Standard Kerb as per TII CC-SCD-01101 Type A, 125mm from top of kerb to proposed carriageway level (Refer to drawing CC-SCD-01101)
- Proposed carriageway
- Proposed concrete footpath as per TII CC-SCD-01105 Type 1 (Refer to drawing CC-SCD-01105)
- Proposed green area

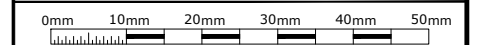

Rev	By	Date	Description
A0	MD	03/07/2024	Preliminary

**© Copyright**  
 The information on this drawing is confidential and must not be disclosed to any third party or reproduced, in whole or part, without the express written consent of Cork County Council. All drawings remain the property of Cork County Council. Includes Ordnance Survey Ireland data reproduced under OSI Licence number 2024 / OSI\_NMA\_045 / Cork County Council. Unauthorised reproduction infringes Ordnance Survey Ireland and Government of Ireland copyright. © Ordnance Survey Ireland, year 2024.

**CORK COUNTY COUNCIL**  
 Regional & Local Roads Design Office  
 Floor 3  
 County Library Building  
 Carrigrohane Road, Cork, T12 K335.

Project: **R572 GLENGARRIFF FOOTPATH**

Drawn: **PROPOSED LAYOUTS**  
 Sheet 3 of 3

MD	MD	DOR	AP	19.07.2024	1:500	A3
19 July 2024						
<b>PRELIMINARY</b>						R572 - LA - 03
						A0