

LEGEND

- CLASS A INDIVIDUAL TREE (HIGH QUALITY - RETENTION HIGHLY DESIRABLE)
- CLASS B INDIVIDUAL TREE (MODERATE QUALITY - RETENTION DESIRABLE)
- CLASS C INDIVIDUAL TREE (LOW QUALITY - RETENTION OPTIONAL)
- CLASS U INDIVIDUAL TREE (RECOMMEND REMOVAL)
- TREE GROUPS or HEDGEROWS (COLOUR REPRESENTING GROUP CLASSIFICATION)
- EXISTING WOODLAND
- CALCULATED ROOT

NOTE:
THIS DRAWING IS PRODUCED IN COLOUR, MONOCHROME VERSIONS SHALL NOT BE RELIED UPON.

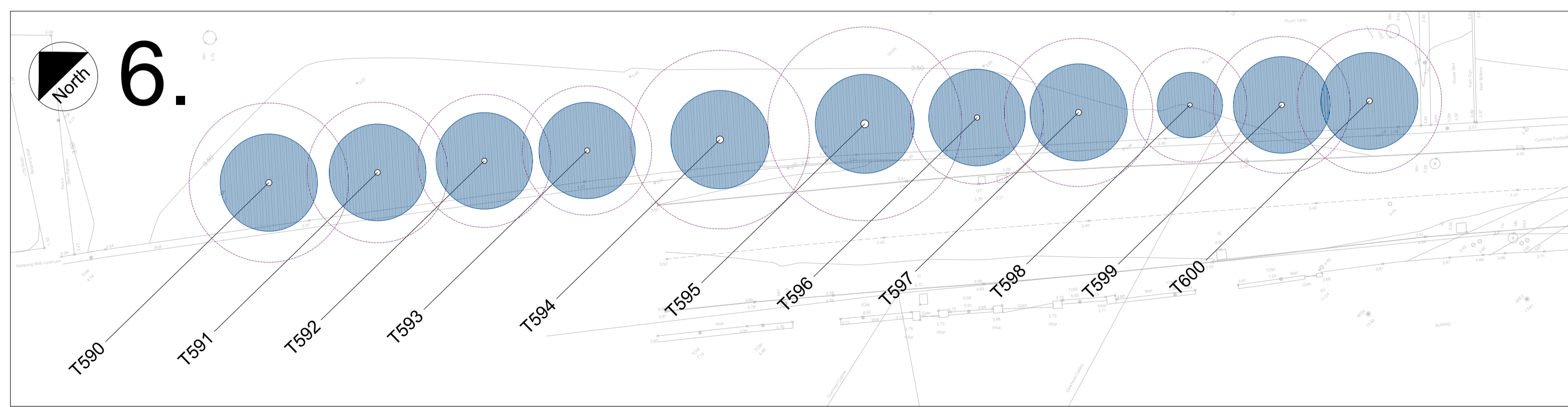
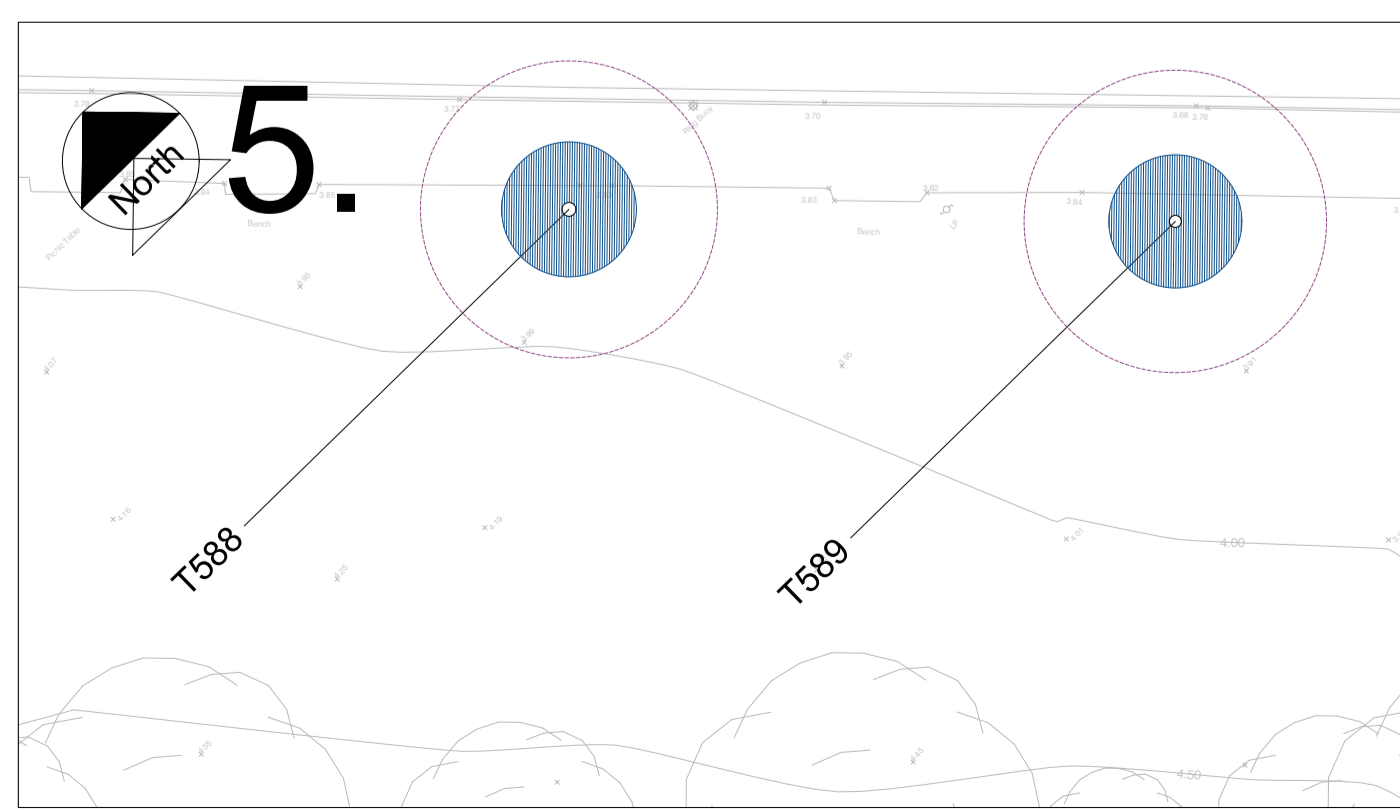
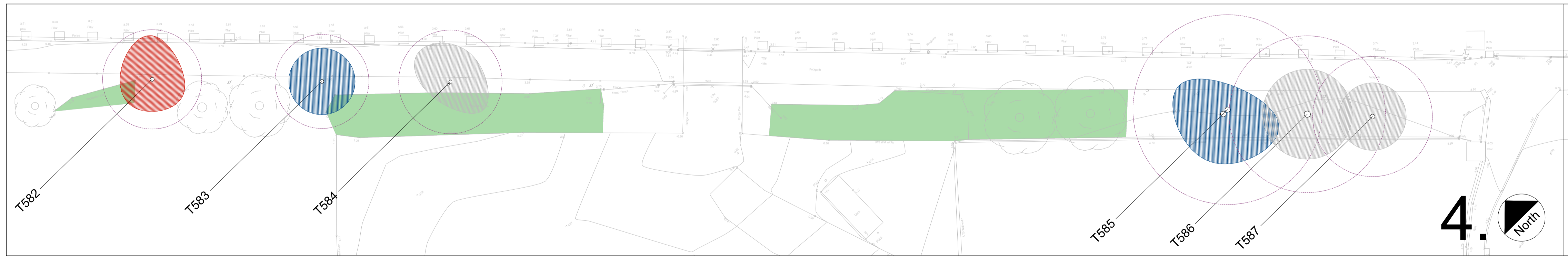
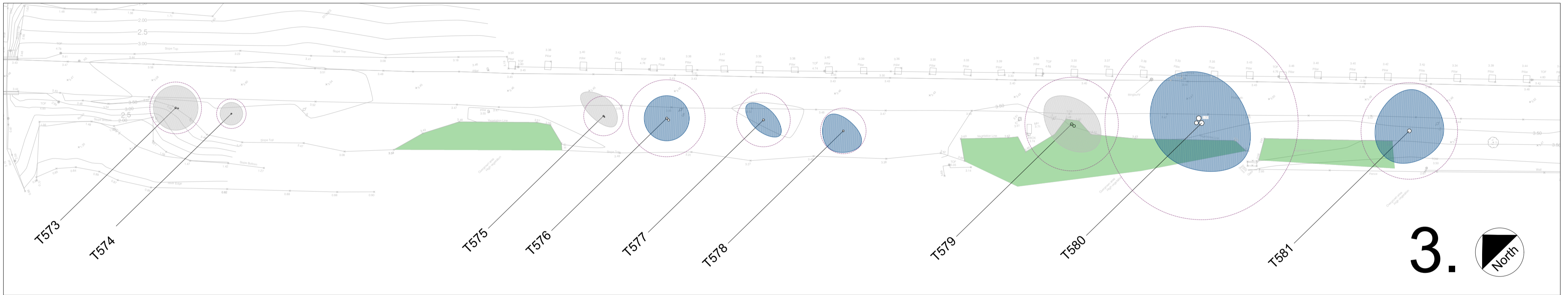
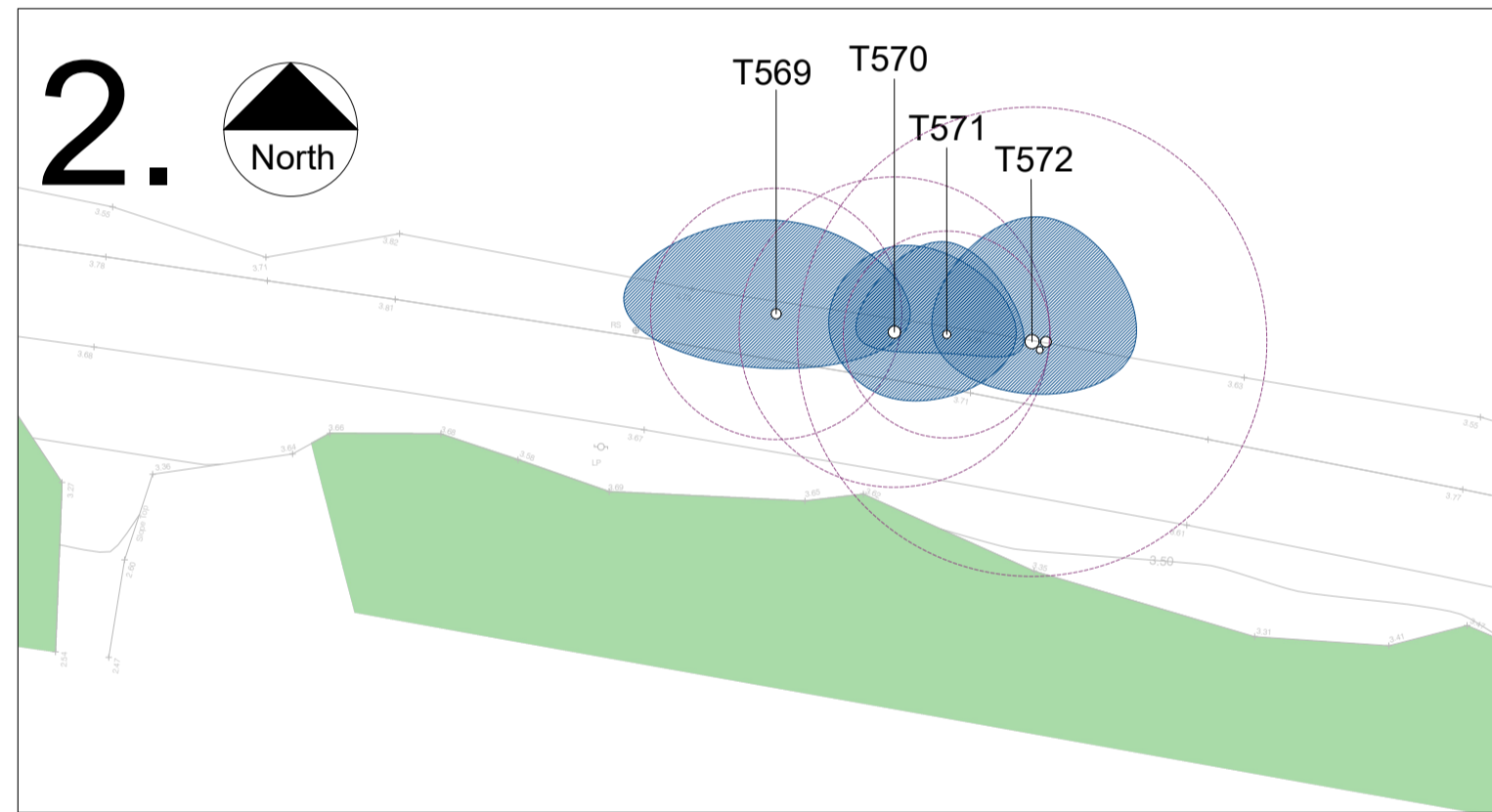
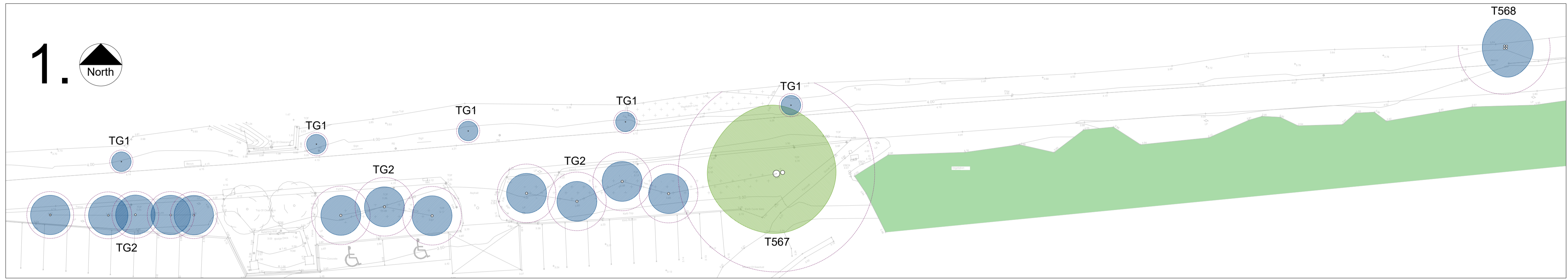

REV	DATE	AMENDMENT



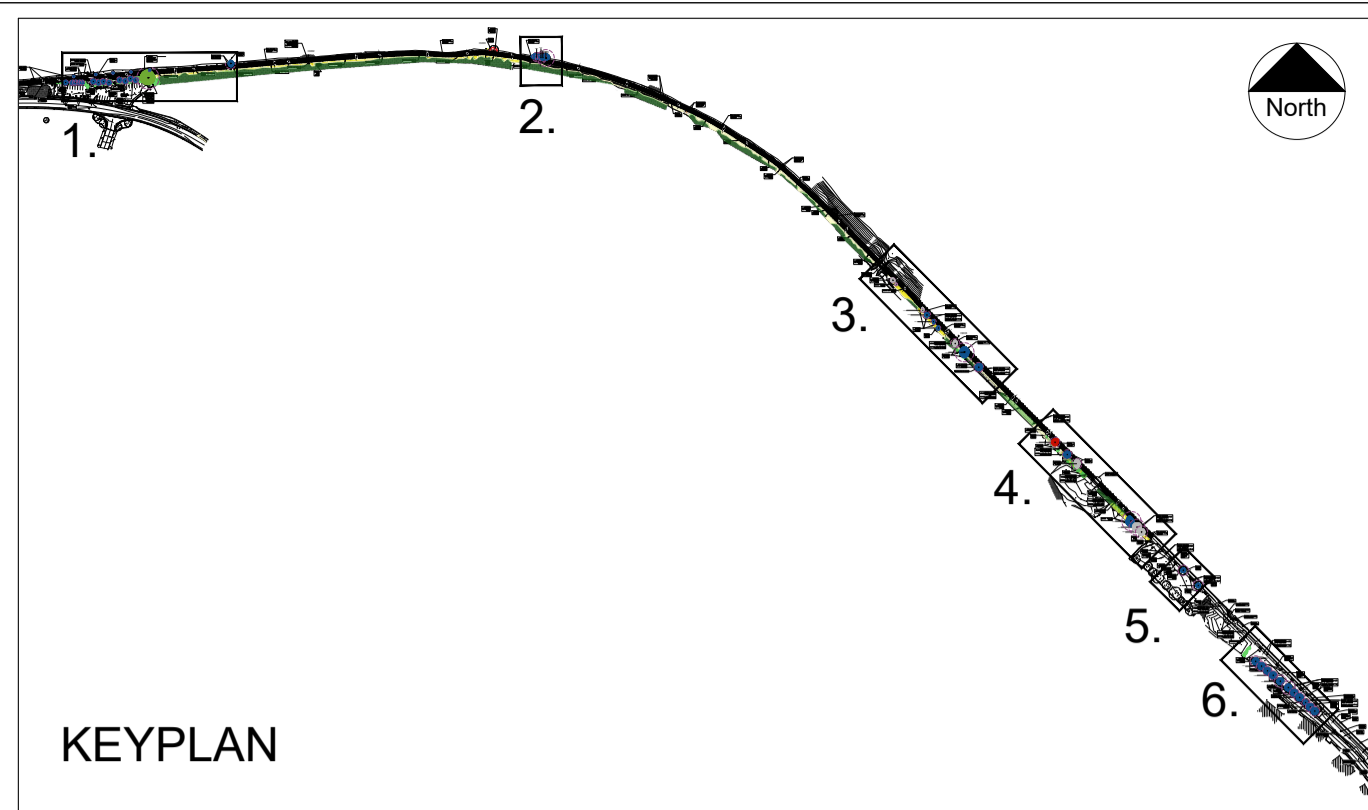

CUNNANE STRATTON REYNOLDS
LAND PLANNING & DESIGN

GALWAY OFFICE
 ARDACONG, BALLYTRASNA, TUAM, CO GALWAY
 email: galwayinfo@csrlandplan.ie
 www.csrlandplan.ie

PROJECT: PASSAGE WEST CORK	DATE: MAY 2023
DRAWING: TREE SURVEY - CLASSIFICATION & CONSTRAINTS	SCALE: 1:250@A1
	DRAWN: KM
	CHECKED: KM
	DRAWING NO: 23255_T_101

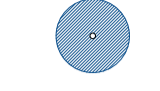
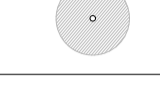
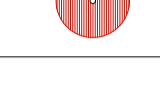

LEGEND

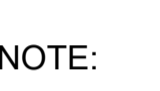
-  CLASS A INDIVIDUAL TREE (HIGH QUALITY - RETENTION HIGHLY DESIRABLE)
-  CLASS B INDIVIDUAL TREE (MODERATE QUALITY - RETENTION DESIRABLE)
-  CLASS C INDIVIDUAL TREE (LOW QUALITY - RETENTION OPTIONAL)
-  CLASS U INDIVIDUAL TREE (RECOMMEND REMOVAL)
-  TREE GROUPS or HEDGEROWS (COLOUR REPRESENTING GROUP CLASSIFICATION)
-  EXISTING WOODLAND
-  CALCULATED ROOT
-  TREES PROPOSED FOR REMOVAL

NOTE:
THIS DRAWING IS PRODUCED IN COLOUR, MONOCHROME VERSIONS SHALL NOT BE RELIED UPON.

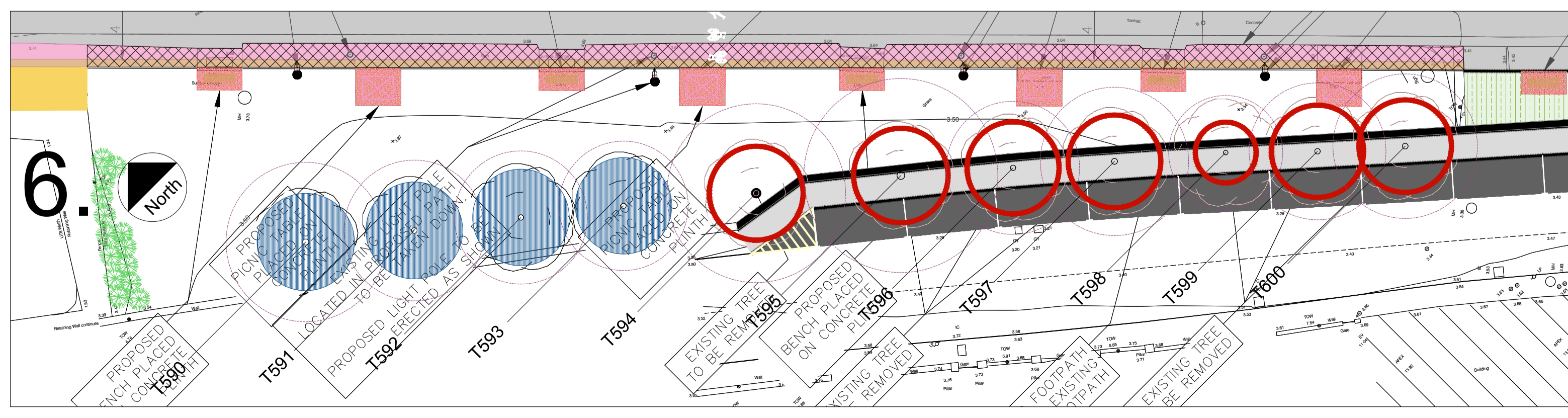
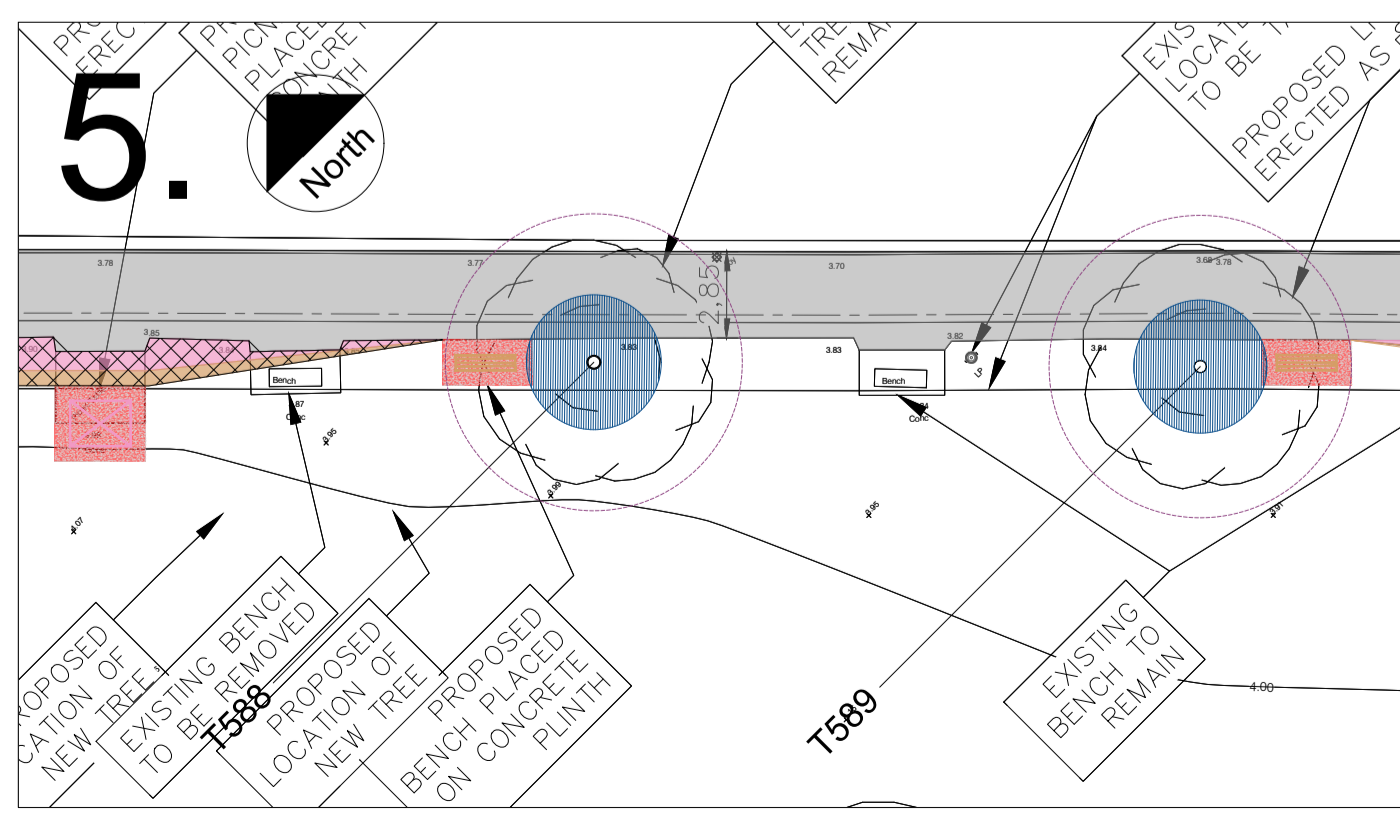
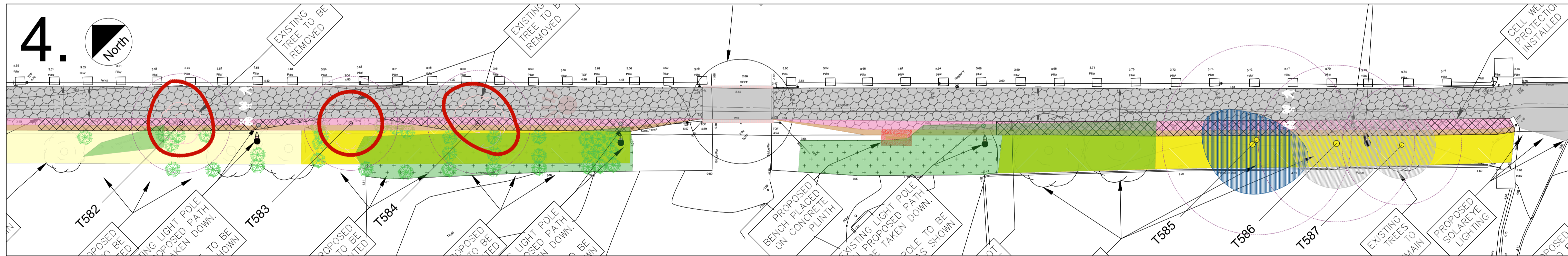
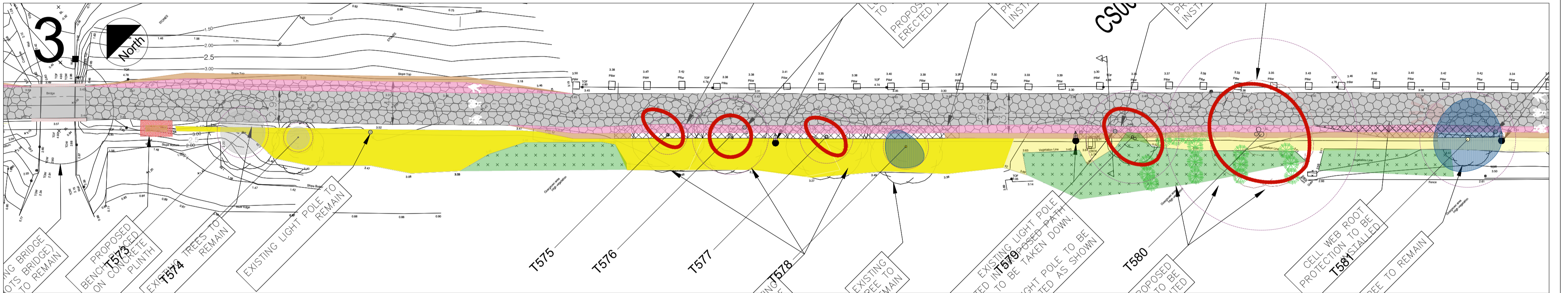
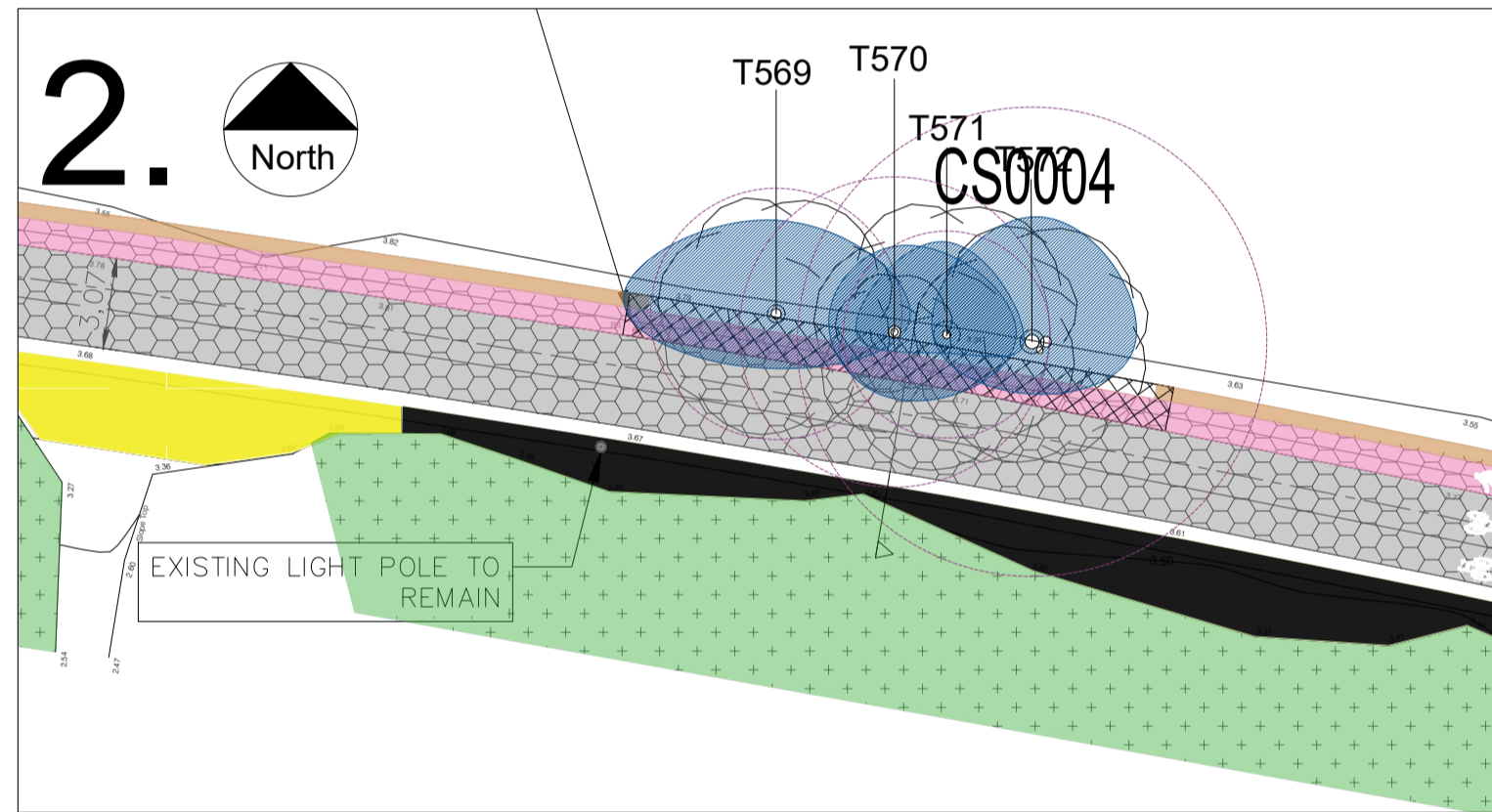
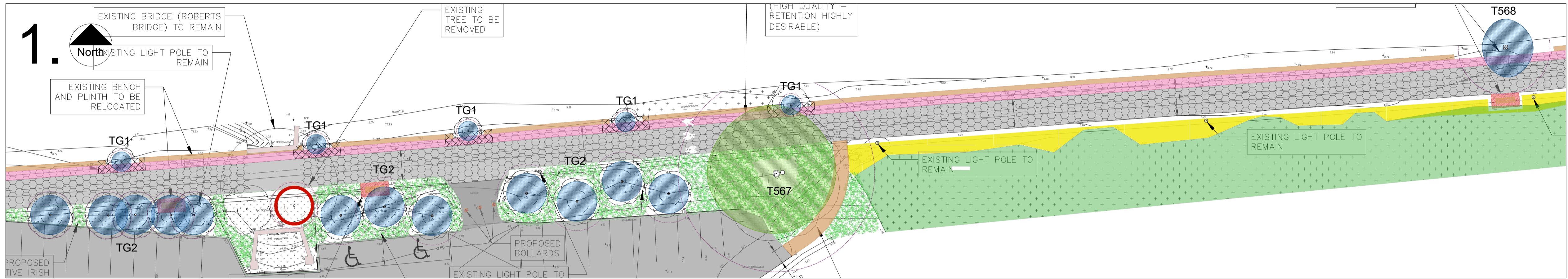

REV	DATE	AMENDMENT
A	AUG 24	UPDATED LAYOUT



CUNNANE STRATTON REYNOLDS
LAND PLANNING & DESIGN

GALWAY OFFICE
ARDA CONG, BALLYTRASNA, TUAM, CO GALWAY
email: galwayinfo@csrandplan.ie
www.csrandplan.ie

PROJECT:	DATE:	JULY 2023
PASSAGE WEST CORK	SCALE:	1:250@A1
DRAWING:	DRAWN:	KM
TREE SURVEY - ARBORICULTURAL IMPACT ASSESSMENT	CHECKED:	KM
	DRAWING NO:	23255_T_102

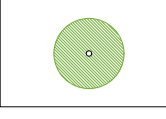
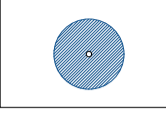
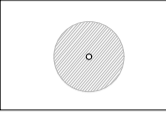
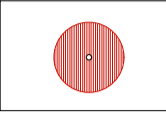
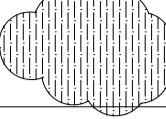

LEGEND

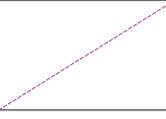
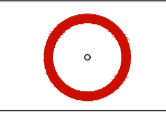
-  CLASS A INDIVIDUAL TREE (HIGH QUALITY - RETENTION HIGHLY DESIRABLE)
-  CLASS B INDIVIDUAL TREE (MODERATE QUALITY - RETENTION DESIRABLE)
-  CLASS C INDIVIDUAL TREE (LOW QUALITY - RETENTION OPTIONAL)
-  CLASS U INDIVIDUAL TREE (RECOMMEND REMOVAL)
-  TREE GROUPS or HEDGEROWS (COLOUR REPRESENTING GROUP CLASSIFICATION)
-  EXISTING WOODLAND
-  CALCULATED ROOT PROTECTION AREA
-  TREES PROPOSED FOR REMOVAL

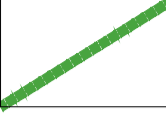
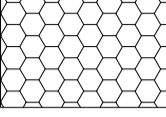
-  TREE PROTECTION FENCELINE (SEE DETAIL)
-  CELLWEB NON-DIG CONSTRUCTION - WITH PERMEABLE TARMAC SURFACE (TO ENGINEERS SPECIFICATION). Note: Minimum area illustrated - may extend further to suit layout.

NOTE: THIS DRAWING IS PRODUCED IN COLOUR. MONOCHROME VERSIONS SHALL NOT BE RELIED UPON.

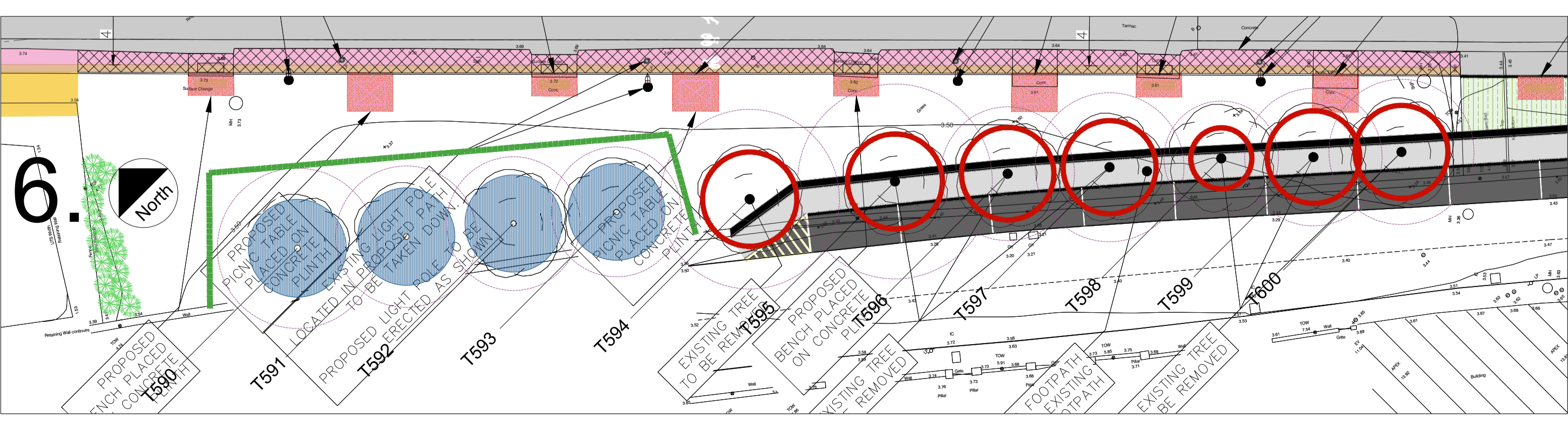
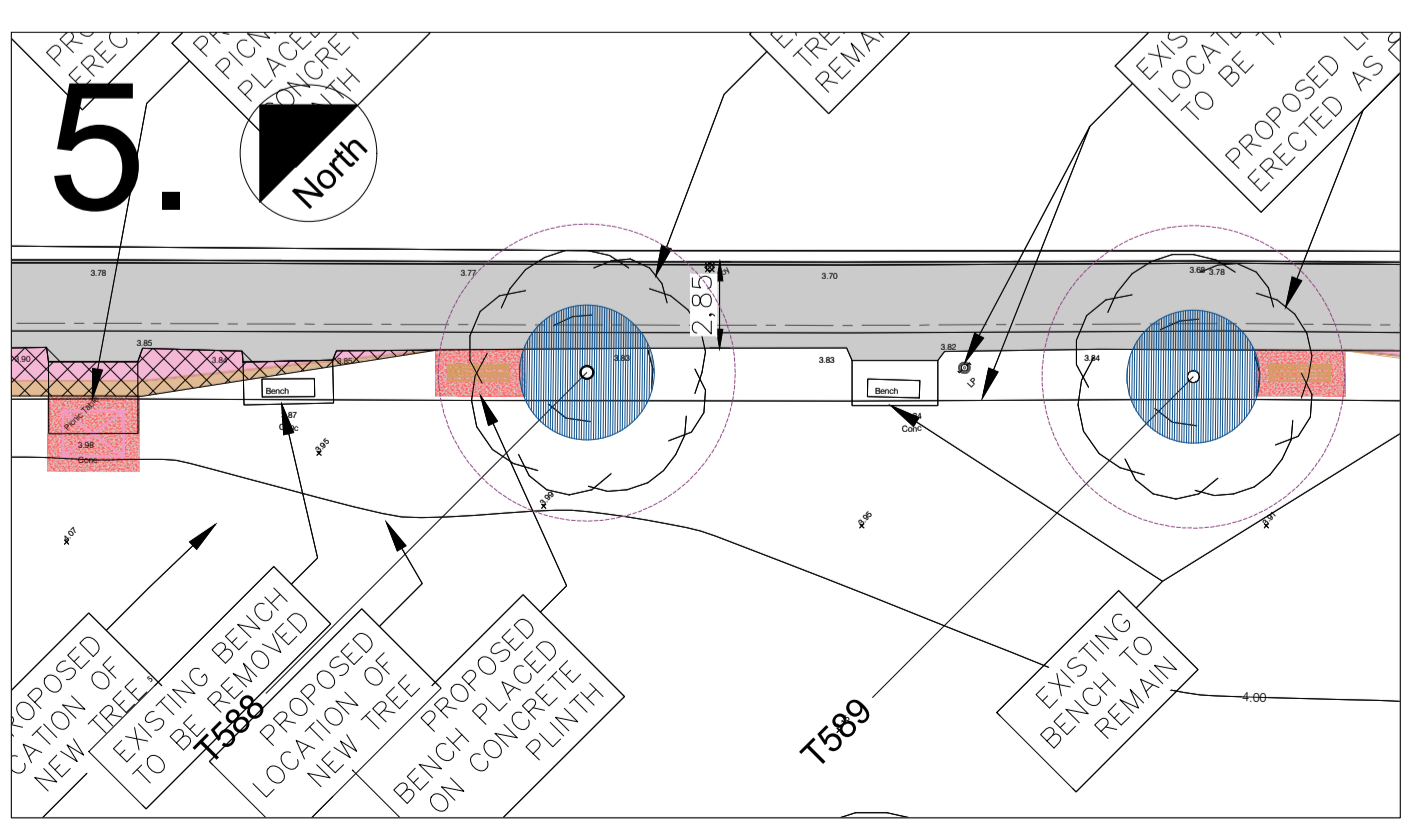
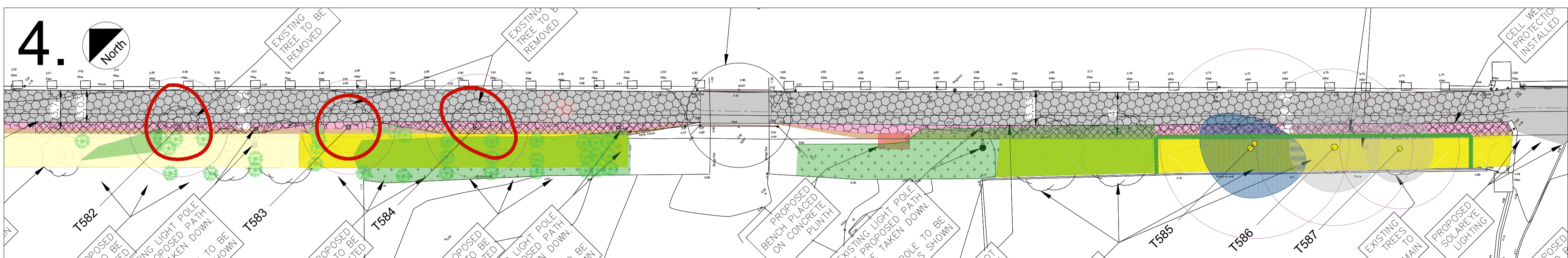
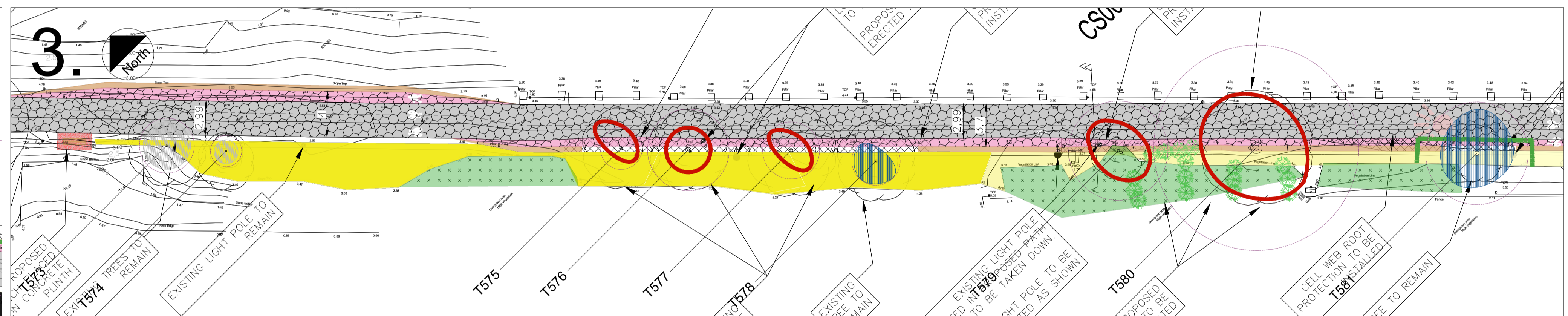
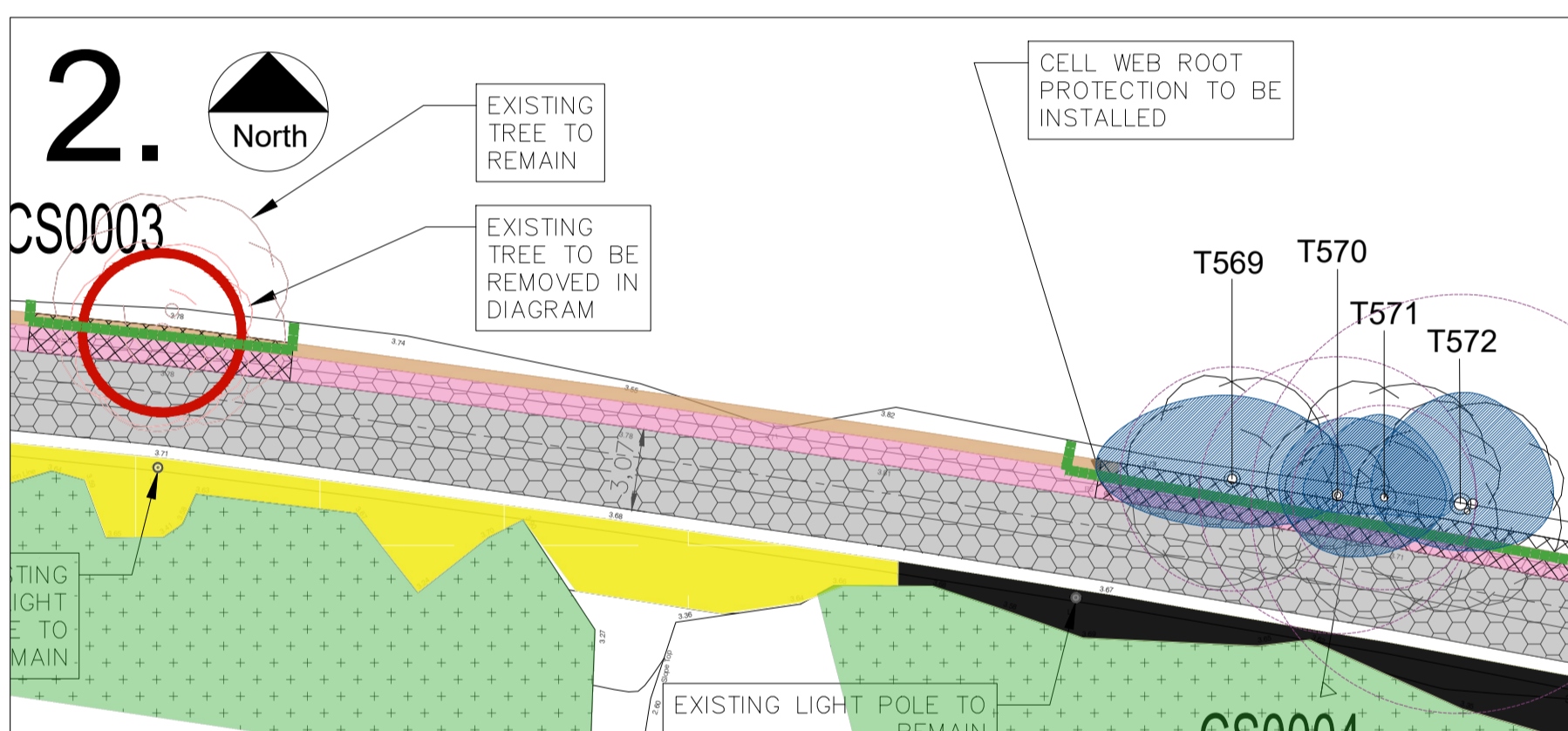
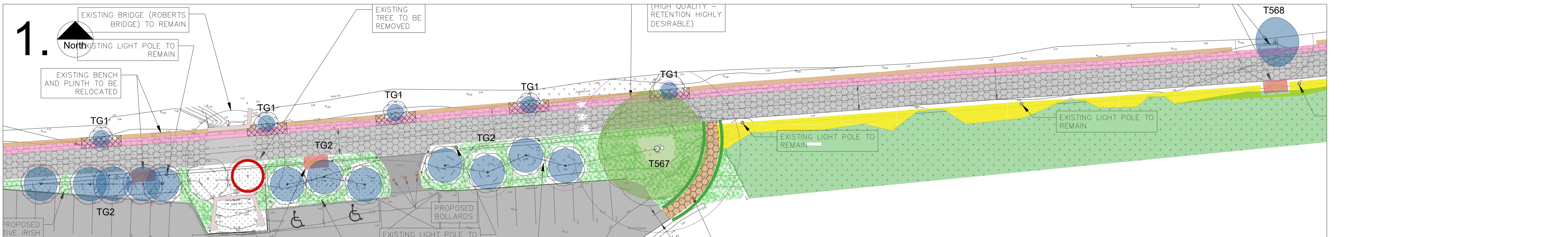
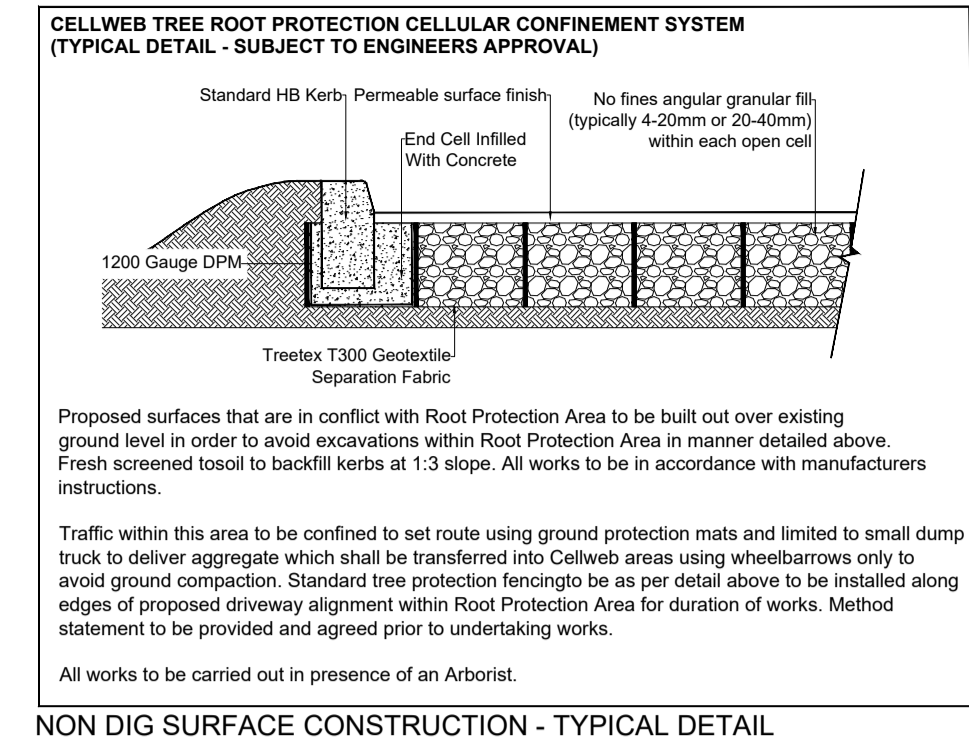
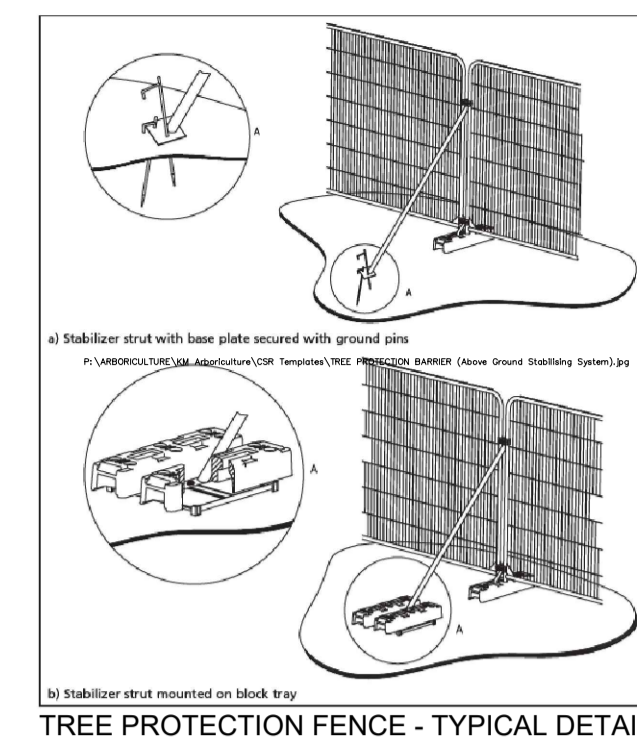

REV	DATE	AMENDMENT
A	AUG 24	UPDATED PROPOSAL

**CUNNANE STRATTON REYNOLDS
LAND PLANNING & DESIGN**

GALWAY OFFICE
ARDA CONG, BALLYTRASNA, TUAM, CO GALWAY
email: galwayinfo@csrlandplan.ie
www.csrlandplan.ie

PROJECT:	DATE:	JULY 2023
PASSAGE WEST CORK	SCALE:	1:250@A1
DRAWING:	DRAWN:	KM
TREE PROTECTION	CHECKED:	KM
	DRAWING NO:	23255_T_103