

Cork County Council



Proposed Traffic Calming Works on the R579/L1305 at Johnsbridge, Kanturk, Co Cork

Drawing Schedule

Drawing No.	Drawing Title	Rev.	Size
R579-LM-01_D0	Site Location Map	D0	A3
R579-LA-01_D0	Existing Site Layout Plan	D0	A3
R579-LA-02_D0	Proposed Site Layout Plan	D0	A3

Section 38

Regional & Local Road Design Office

Floor 3

County Library Building

Carrigrohane Road, Cork, T12 K335.

February 2025

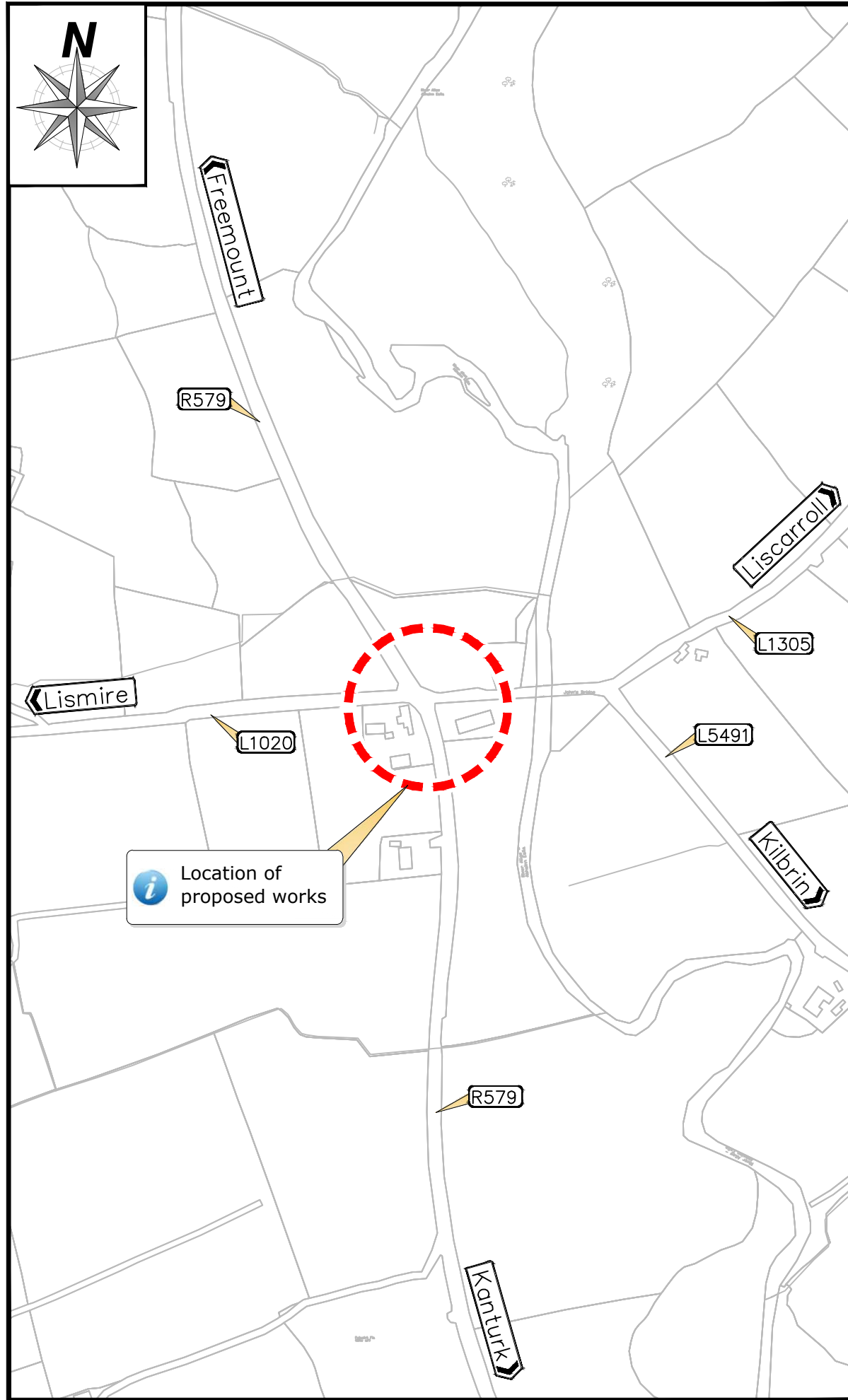

Site Location Map (Not to Scale)

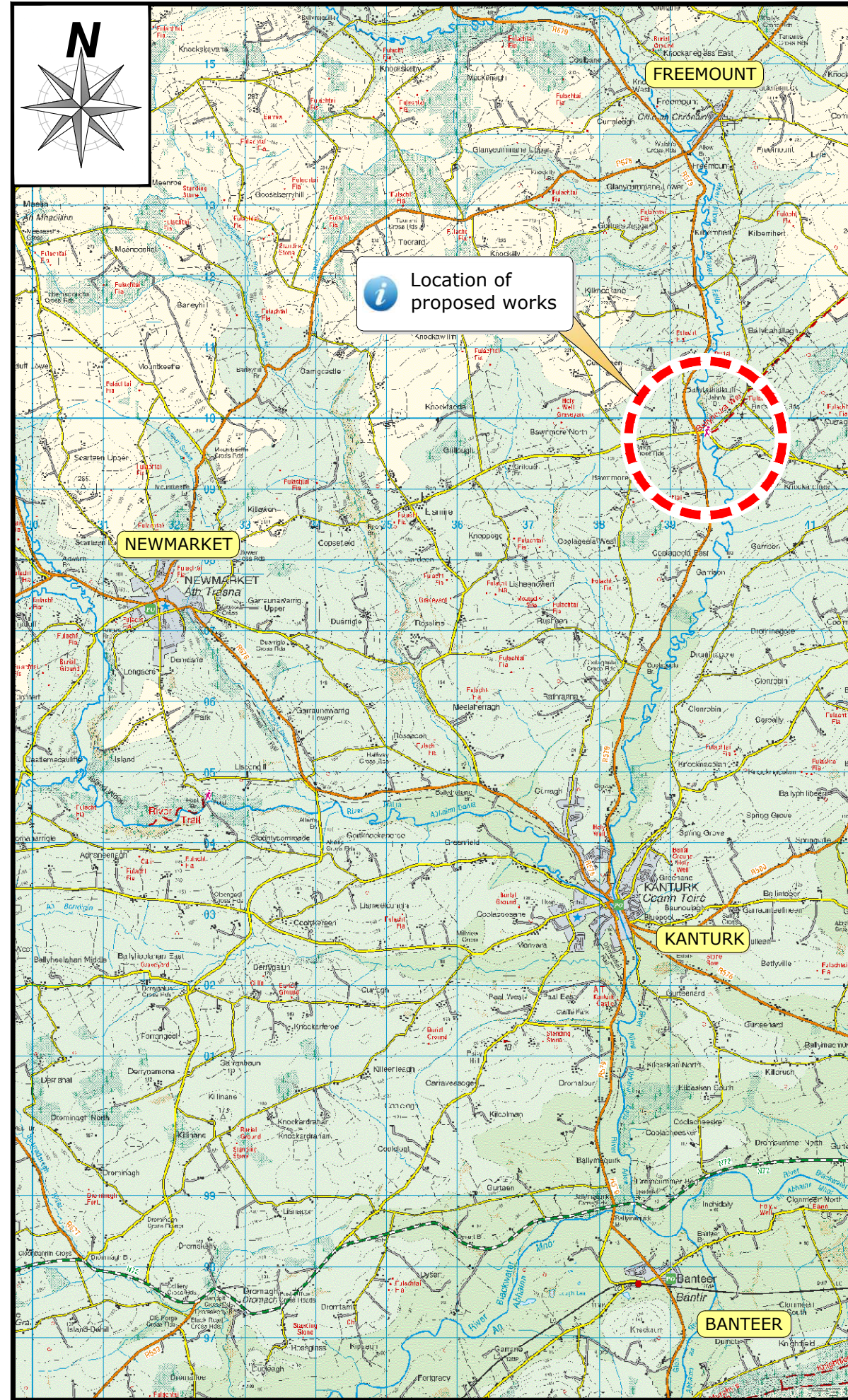

Site Location Map (Not to Scale)

NOTES

Dimensions not to be scaled from Drawing. Any queries to be conveyed to the CCC Road Design Office, Innishmore, Ballincollig.

The information shown on this plan is a general guide and the accuracy thereof cannot be guaranteed. No liability is accepted for any discrepancy, omission or deviation and the actual position of services and underground plant must be established on site before any mechanical excavation is undertaken.

LEGEND

 Scheme Location

Rev	By	Date	Description
01	JM	29-01-25	Section 38

© Copyright
 The information on this drawing is confidential and must not be disclosed to any third party or reproduced, in whole or part, without the express written consent of Cork County Council. All drawings remain the property of Cork County Council.
 Includes Ordnance Survey Ireland data reproduced under OSI Licence number 2020/06/CMA/CorkCountyCouncil.
 Unauthorised reproduction infringes Ordnance Survey Ireland and Government of Ireland copyright. © Ordnance Survey Ireland, 2024.

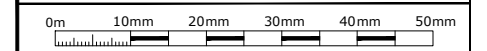

 **CORK COUNTY COUNCIL**
 Regional & Local Roads Design Office
 Floor 3, County Library Building,
 Carrigrohane Road, Cork, T12 K335.

Project: **Kanturk Mallow Municipal District
 R579 Johnsbridge Junction, Kanturk**

Title: **Site Location Map**

Project	Drawn	Checked	Issue Date	Issue	Scale
JM	JM	MC	22.08.2023	NTS	##
14 February 2025					
Section 38				R579-LM-01	D0

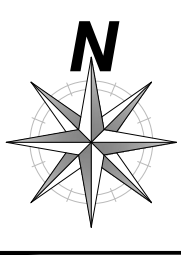

NOTES

- 1 All dimensions in metres unless otherwise stated.
- 2 Dimensions not to be scaled from drawing. Any queries to be conveyed to the CCC Road Design Office, Innishmore, Ballincollig.
- 3 All road markings are white in colour unless noted otherwise.
- 4 The information shown on this plan is a general guide and the accuracy thereof cannot be guaranteed. No liability is accepted for any discrepancy, omission or deviation and the actual position of services and underground plant must be established on site before any mechanical excavation is undertaken.

LEGEND

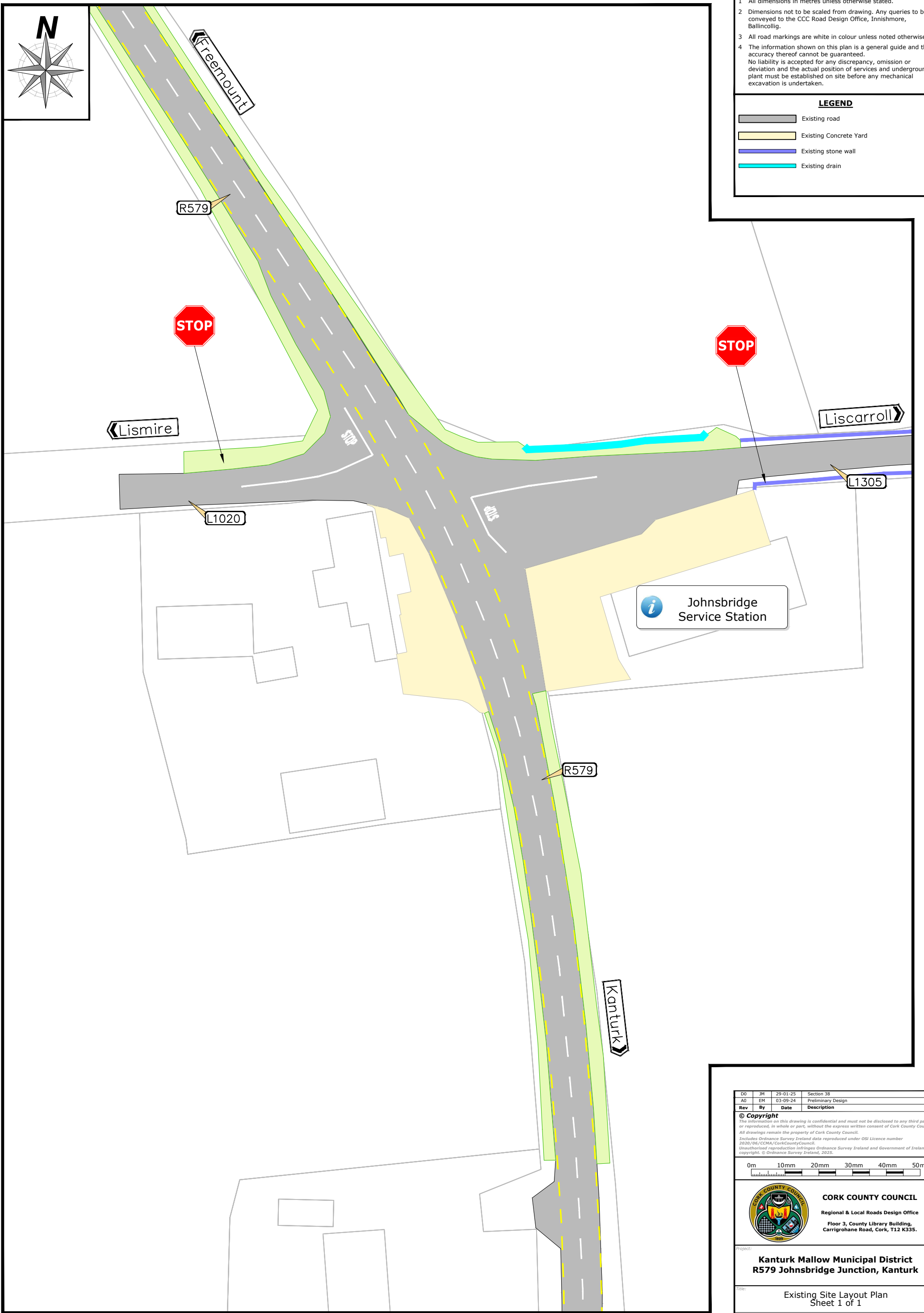

- Existing road
- Existing Concrete Yard
- Existing stone wall
- Existing drain



Site Layout Plan

Rev	By	Date	Description
D0	JM	29-01-25	Section 38
A0	EM	03-09-24	Preliminary Design

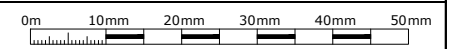
© Copyright
 The information on this drawing is confidential and must not be disclosed to any third party or reproduced, in whole or part, without the express written consent of Cork County Council. All drawings remain the property of Cork County Council.
 Includes Ordnance Survey Ireland data reproduced under OSI Licence number 2020/06/CCMA/CorkCountyCouncil.
 Unauthorised reproduction infringes Ordnance Survey Ireland and Government of Ireland copyright. © Ordnance Survey Ireland, 2025.





CORK COUNTY COUNCIL
 Regional & Local Roads Design Office
 Floor 3, County Library Building,
 Carrigrohane Road, Cork, T12 K335.

Project:
**Kanturk Mallow Municipal District
 R579 Johnsbridge Junction, Kanturk**

Title:
 Existing Site Layout Plan
 Sheet 1 of 1

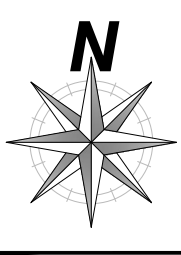
Author	Check	Drawn	Date	Scale	Sheet
JM	JM	MC	29.01.2025	NTS	A3
Date:			14 February 2025		
Section:			**Section 38**	R579 - LA - 01	D0



NOTES

- All dimensions in metres unless otherwise stated.
- Dimensions not to be scaled from drawing. Any queries to be conveyed to the CCC Road Design Office, Innishmore, Ballincollig.
- All road markings are white in colour unless noted otherwise.
- The information shown on this plan is a general guide and the accuracy thereof cannot be guaranteed. No liability is accepted for any discrepancy, omission or deviation and the actual position of services and underground plant must be established on site before any mechanical excavation is undertaken.

LEGEND

- Existing road
- Existing Concrete Yard
- Proposed footpath/buildout
- Proposed yellow road marking hatching
- Proposed white road marking hatching
- Existing stone wall
- Existing drain
- Proposed Keep Right Flexible Bollards TMP Flecta or approved similar

The location of all signs and road markings are to be agreed onsite with the engineer prior to installation.

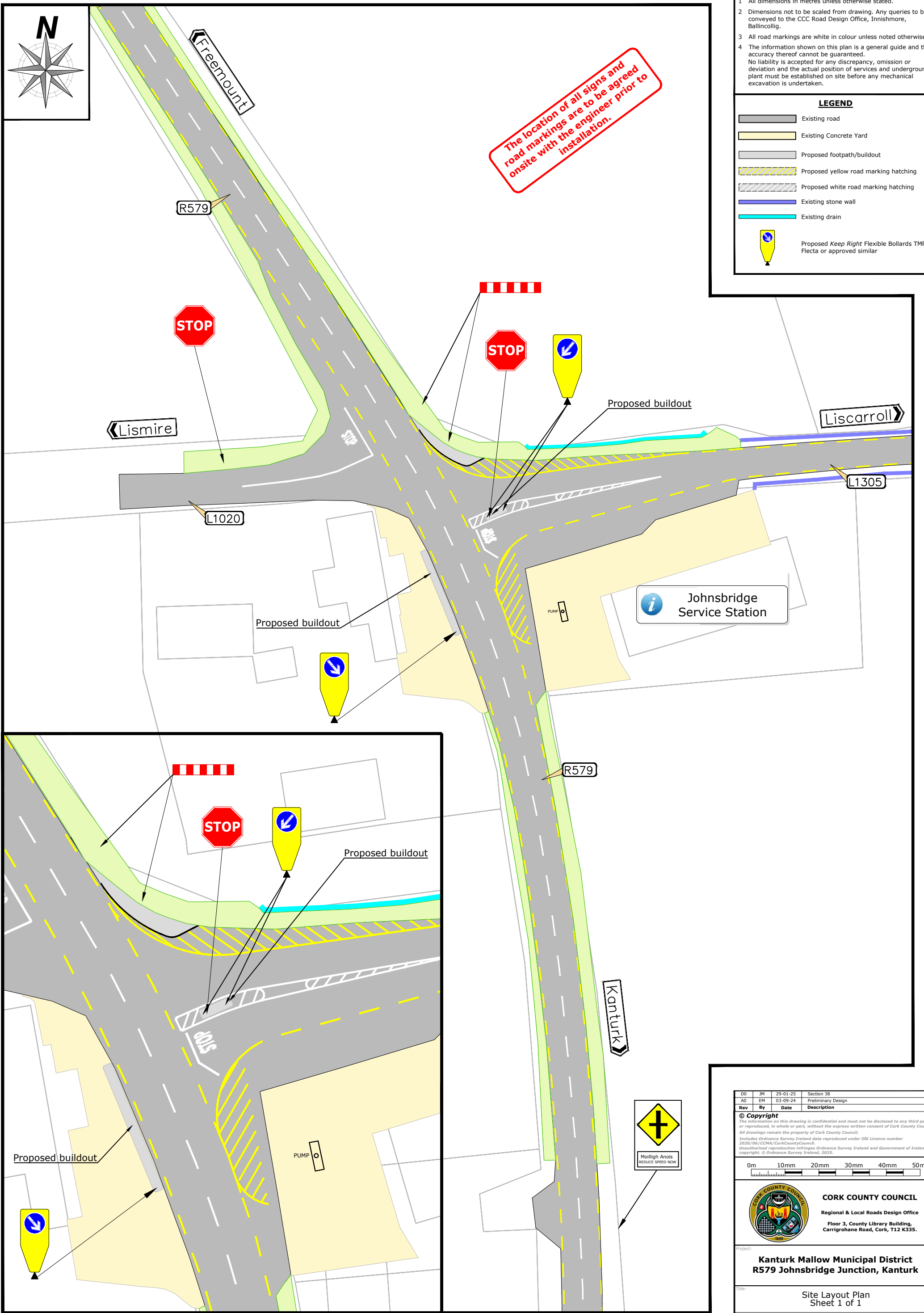

Site Layout Plan

DO	JM	29-01-25	Section 38
AD	EM	03-09-24	Preliminary Design
Rev	By	Date	Description

© Copyright
 The information on this drawing is confidential and must not be disclosed to any third party or reproduced, in whole or part, without the express written consent of Cork County Council. All drawings remain the property of Cork County Council.
 Includes Ordnance Survey Ireland data reproduced under OSI Licence number 2020/06/CCMA/CorkCountyCouncil.
 Unauthorised reproduction infringes Ordnance Survey Ireland and Government of Ireland copyright. © Ordnance Survey Ireland, 2025.

0m 10mm 20mm 30mm 40mm 50mm

CORK COUNTY COUNCIL
 Regional & Local Roads Design Office
 Floor 3, County Library Building,
 Carrigrohane Road, Cork, T12 K335.

Project:
**Kanturk Mallow Municipal District
 R579 Johnsbridge Junction, Kanturk**

Title:
 Site Layout Plan
 Sheet 1 of 1

Author	JM	MC	MC	NTS	A3
Date	14 February 2025				
Section	**Section 38**				
Project No	R579-LA-02				D0